

Brief and handy: everything your dishwasher needs.  
Before using for the first time, read the installation and operating instructions!

# Setting the water softening system \*

Find out the water hardness at your water utility company and enter below

\* only before using the dishwasher for the first time or if the water hardness changes

## Read off the setting

*dH	°fH	*Clarke	mmol/l	Setting
0-6	0-11	0-8	0-1,1	0
7-16	12-29	9-20	1,2-2,9	1
17-21	30-37	21-26	3,0-3,7	2
22-35	38-60	27-44	3,8-6,2	3

A

B

C

Reset

## Quickly sorted

### and then select a setting

- Hold down programme button **B** and switch on the main switch, then release the buttons. The display flashes and buttons **A** and **B** illuminate (water hardness setting was set to 2 at the factory).
- Each time button **B** is depressed, the setting increases by one (0-3). If buttons **A**, **B** and **C** illuminate, the maximum water hardness setting has been reached. If the water hardness setting is now increased again, the lights go out and the water hardness setting is set to 0.
- Switch off the main switch. The selected setting has been stored in the appliance.

Dissolves limescale (not required for set value 0!)

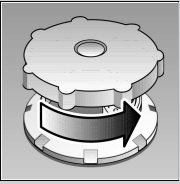

Unscrew the lid.

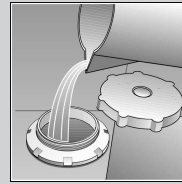

Only before using the dishwasher for the first time pour approx. 1 l / 2 pt water into the salt opening.

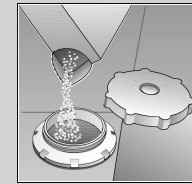

Pour in max. 1.5 kg / 3 lb 5 oz salt (never detergent!)

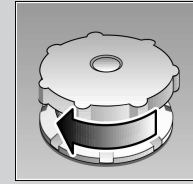

Screw on the lid. Switch on dishwasher immediately.

Everything is sparkling clean ...

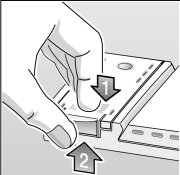

Press mark 1, lift up lid 2.



Refill whenever level indicator is light!

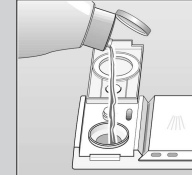

Pour in rinse aid.

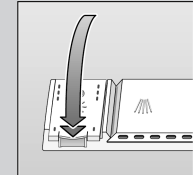

Close the lid. CLICK!

Very dirty dishes, a lot of detergent ...

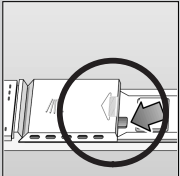

If required, open the lid (press the pin).



Warning, combination products are not suitable for all programmes, follow manufacturer's instructions.

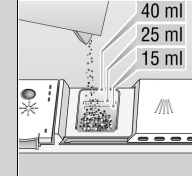

Pour in detergent.

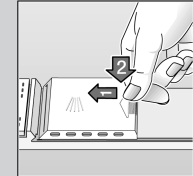

Push the lid shut, press. PLOP!

Quick, economical or intensive ...

## Overview of programmes

This overview indicates the max. possible number of programmes. The programmes which correspond to your appliance can be found on your appliance fascia.

The programme data are values measured in the laboratory in compliance with Standard EN 50242. Deviations in practice are possible.

	Intensive 70° 	Normal 65° 	Eco 50° 	Gentle 40° 	Quick 35° 	Prerinse 
Duration in minutes	115	140	140	75	30	19
Power consumption in kWh	1,70	1,60	1,05	0,90	0,70	0,10
Water consumption in litres	21	19	14	15	10	4

## Programme progress / Rinsing noises

Example: Eco programme

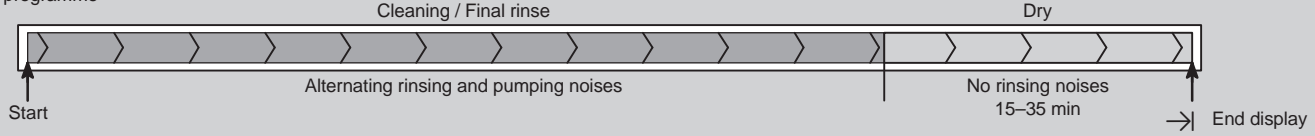

After the drying cycle, water is pumped out for approx. 60 sec. The programme has not ended until the end display → lights up

Maintenance and care

Strainers ...

Check, if required, clean

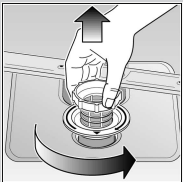

Rotate filter cylinder, remove filter system ...

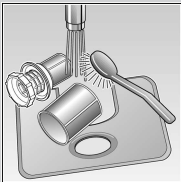

rinse under flowing water ...

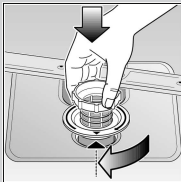

Insert ...

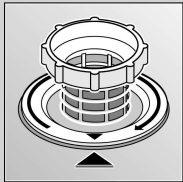

Screw in filter system NOTE MARK!

Spray arms ...

Remove blockages/deposits

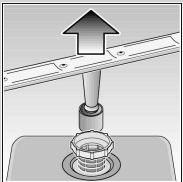

Pull lower arm upwards ...

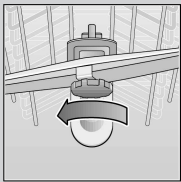

Unscrew upper arm ...

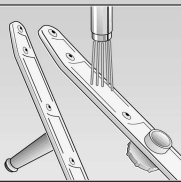

Clean spray nozzles under flowing water (perhaps with toothpick) ...

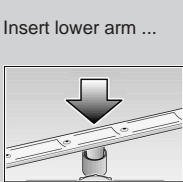

Insert lower arm ...

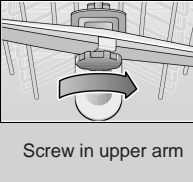

Screw in upper arm

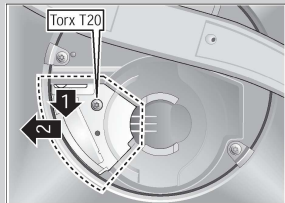

- \* With some models
- Ladle out water and remove filters
  - Unscrew cover (Torx T20)
  - Check area of fan impeller for foreign objects
  - Screw in cover and insert filters

Eliminating minor faults yourself ...

... Self-help pays!

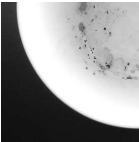
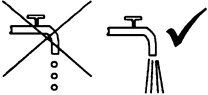
Fault	Possible Cause	Remedy	Fault	Possible Cause	Remedy
Residual water in the device	Waste-water pump blocked Programme not yet ended	<ul style="list-style-type: none"><li>▶ Clean waste-water pump (see above).</li><li>▶ Close and switch on the appliance and wait until the programme ends (end of programme display lights up) or terminate programme (see Terminating the programme).</li></ul>	Dishes not clean Sand or grainy residues on dishes	Utensils are situated too close to each other or on top of each other Too little cleaning product  Unsuitable programme selected Spray nozzles blocked Filters dirty, not installed securely Spray arms blocked	<ul style="list-style-type: none"><li>▶ Spread out the utensils, avoid contact between the utensils.</li><li>▶ Follow manufacturer's specifications (detergent).</li><li>▶ Select more intensive programme.</li><li>▶ Clean spray arms (see above).</li><li>▶ Clean the strainers (see above).</li><li>▶ Arrange the utensils so that the spray arms can rotate freely.</li></ul>
Device does not work/stops	Supply fitting not open Supply hose kinked Supply fitting jammed or calcified 	<ul style="list-style-type: none"><li>▶ Open supply fitting.</li><li>▶ Lay supply hose without kinks.</li><li>▶ 1. Unscrew water connection.</li><li>▶ 2. Clean filter in the water connection.</li><li>▶ 3. Flow rate must be min. 9 l/min when the water inlet is open.</li><li>▶ If the flow rate is less, replace the supply fitting.</li></ul>	Stains and streaks	Rinse aid dosage too high / too low	<ul style="list-style-type: none"><li>▶ Streaks: Reduce dosage.</li><li>▶ Water or limescale stains: Increase dosage.</li></ul>
Plastic parts / parts of dishes discoloured	Too little cleaning product Discoloration caused by food colourings (tomato sauce)	<ul style="list-style-type: none"><li>▶ Follow manufacturer's specifications (detergent).</li><li>▶ Discoloration is quite safe; fades after subsequent rinse cycles.</li></ul>	Milky residues on dishes (can be removed)	Water softening system incorrectly set; no special salt	<ul style="list-style-type: none"><li>▶ Set water softening system correctly.</li><li>▶ Refill with special salt.</li></ul>
			Milky film, glasses cloudy / dull (cannot be removed)	Glasses not dishwasher-proof.	<ul style="list-style-type: none"><li>▶ Use dishwasher-proof glasses.</li><li>▶ Use glass-friendly cleaning products.</li></ul>
			Cutlery rusty	Cutlery not rust-proof Hard knife blades are more susceptible Extraneous rust	<ul style="list-style-type: none"><li>▶ Use dishwasher-proof cutlery.</li><li>▶ Never wash rusting parts in the appliance.</li></ul>

Further advice can be found in the instruction manual

Interrupting the programme

- Switch off the main switch.
- To continue the programme, switch on the main switch again.

Cancelling the programme

While the programme is running, **simultaneously** press the two **Reset** buttons for approx. 3 seconds (RESET).

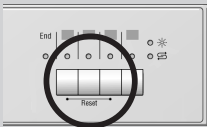

1 minute after the programme has ended, the "programme end" display illuminates.

Switch off the appliance.

Arranging utensils

Arrange dishwasher-proof utensils (without any residual ash, wax, grease, ink, sticky labels; remove large remnants of jam, dairy products and food) according to the operating instructions and check that the spray arms can rotate freely.