

Invented for life

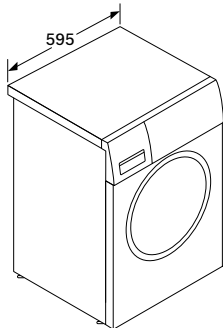
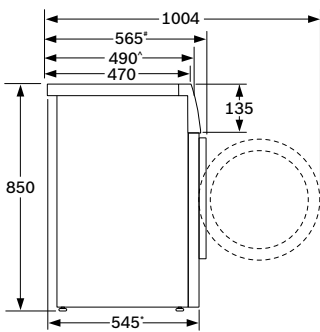

WHE25300HK		\$8,600
Slimline Expert 10 Series Frontload Washer		
Design & Features	<ul style="list-style-type: none"> • Serie 4 • Slimmest Ever: Designed for Hong Kong family, slimmest in design, biggest in capacity. 10KG big capacity for entire family. • Hygiene Expert: Steam wash to remove 99.99% Bacteria** • Guard your machine : Drum Clean program to remove stubborn stains, bacteria and mold inside drum without need any disinfectants 	
Programmes & additional options	<ul style="list-style-type: none"> • Memory, Cottons, Intensive, Mix, Delicates/Silk, Easy-Care, Shirts, Rinse/Spin, Drum Clean, Cottons Night Wash, Hygiene 65°C , Sportswear, Quick 15', Kidswear, Wool, Spin/Drain • Options: SpeedPerfect, Temperature selection, Spin speed selection, Finish in time selection, Prewash, Extra Rinse, HygienicWash, Start/Reload 	
Technology	<ul style="list-style-type: none"> • EcoSilence Drive™: Extremely energy-efficient and silent in operation with long lifetime guaranteed for 10 years • Super suspension system: 4 suspension axels • Multi-function display • Electronic control dials and large LED-Display for program status indication. remaining time, temperature, spin speed, additional options and 24 hours end time delay • Drum clean reminder • Buzzer to indicate the end of cycle 	
Safety functions	<ul style="list-style-type: none"> • Foam detection and unbalanced load detection • Childproof lock 	
Technical information	<ul style="list-style-type: none"> • Washing Capacity: 10kg • Spin speed selection: 400-1300rpm • Hong Kong energy label Grade 1 • Hong Kong water label Grade 1 • Total connected load: 2kW (10A) • Dimensions (H x W x D): 850 x 595 x 490(545*/565*) mm • Power cord length : 200cm 	
Country of origin	<ul style="list-style-type: none"> • China 	

Please reserve 5-10mm as buffer due to possible uneven flooring Please consult product hotline for installation requirement

** Tested by CVC Testing Technology Co., Ltd. for effective bacteria removal of E. coli and Staphylococcus aureus

^ Appliance depth include drainpipes

* Include buttons and drainpipes (exclude door frame thickness)

*Include buttons and drainpipes (Include door frame thickness)

Measurements in mm

Appliance Warranty Registration

