

# 24" Compact Washer

500 Series Washer with Home Connect® – WAW285H1UC



**BOSCH**  
Invented for life



**WAW285H1UC**  
White

The 500 Series laundry pair is recognized as **ENERGY STAR® Most Efficient of 2023** and offers fast wash and dry cycles.

## Features & Benefits

The Bosch 500 Series Washer with Home Connect® can be operated from anywhere.

AquaShield® hose provides protection against water damage.

EcoSilence™ motor delivers quiet, efficient and long lasting performance.

SpeedPerfect® provides up to 40% faster washing time.\*

At 2.2 cu. ft. Bosch washers are compact in size without sacrificing capacity so you can fit a variety of loads.



\*As compared to Perm Press Heavy Soil cycle without SpeedPerfect®

\*\*Stated circuit breaker size is if the appliance is plugged into an individual 240/208V, 15A minimum branch circuit.

**Accessories:** To purchase Bosch accessories, cleaners & parts please visit [www.bosch-home.com/us/store](http://www.bosch-home.com/us/store) or call 1-800-944-2904 (Mon to Fri 5 am to 6 pm PST, Sat 6 am to 3 pm PST).

**Notes:** All height, width and depth dimensions are shown in inches. BSH reserves the absolute and unrestricted right to change product materials and specifications, at any time, without notice. Consult the product's installation instructions for final dimensional data and other details prior to making cutout.

**Warranties:** Please see Use & Care manual or Bosch website for statement of limited warranty.

**For more information on our entire line of products, go to [www.bosch-home.com/us](http://www.bosch-home.com/us) or call 1-800-944-2904**

© BSH Home Appliances Corporation. All rights reserved. Bosch is a registered trademark of Robert Bosch GmbH

## General Properties

Tub material	Stainless Steel
Maximum spin speed	1,400 rpm
Interior light	No
Leak protection systems	AquaShield® Hose
Internal water heater	Yes
Stackable	Yes with Stacking Kit Accessory
Silence level – washing	51 dBA
Silence level – spinning	71 dBA
Programs (No.), [Special]	(14), [Sanitize, Outdoor / Sport]
Options (No.), [Special]	(10), [Remote Start, EcoPerfect™, Stains]
Home Connect® (Wi-Fi enabled)	Yes
Energy consumption	84 kWh/yr
Water consumption	2,379 gal/yr
ENERGY STAR® certified	Most Efficient of 2023

## Capacity

Capacity	2.2 cu. ft.
----------	-------------

## Design Elements

Door ring	Silver
Control type	Premium LED touch
Dial	Illuminated jog dial
Bosch logo on door glass	Yes

## Technical Details

Watts	2,520 W
Circuit breaker	15 A**
Volts	208/220-240 V
Current	10.5 A
Frequency	60 Hz
Power Cord (included) [Type]	(Yes) [240V; NEMA 6-15, 3-prong]

## Technical Details Continued

Power cord length	63" (Full Length)
Drain hose length	57" (Full Length)
Inlet hose length	48" (Full Length)
Door hinge	Left Side (Not Reversible)

## Dimensions & Weight

Overall appliance dimensions (HxWxD)	33 1/4" x 23 1/2" x 25"
Net weight	164 lbs
Minimum stack height	67 3/4"

<sup>†</sup>ADA compliance

- Meets ADA height and access requirements *when installed on pedestal.*
- Meets ADA operable parts requirements for controls and detergent dispenser.

## Accessories

Short Stainless Steel Hose (If needed for plumbing box clearance with AQS hose)	P/N 645787
---	------------

## Dryer Stacking Kits



**WTZ11400UC**

Kit w/ Shelf

**WTZ20410UC**

Kit w/out Shelf

**WTZSB30UC**

Kit w/Brackets

Necessary only when stacking a matching Bosch dryer on top of washer. Shown here for reference only.

## Power Adapters



**WTZPA20UC**

4-Prong

**WTZPA30US**

3-Prong

Matching Bosch Dryers are supplied with WTZPA20UC adapter to fit a standard 4-Prong, 30A, Dryer receptacle (NEMA 14-30R) to power both Bosch Washers and Dryers.

Note: – 3-Prong Adapter may be ordered directly from Bosch (not supplied with Washer or Dryer).  
– Use of two individual NEMA 6-15R or 6-20R receptacles/circuits may be used as alternative means to power Washer and Dryer.



**WMZPW20W**  
Washer Pedestal

# 24" Compact Washer

500 Series Washer with Home Connect® – WAW285H1UC



## Installation Details

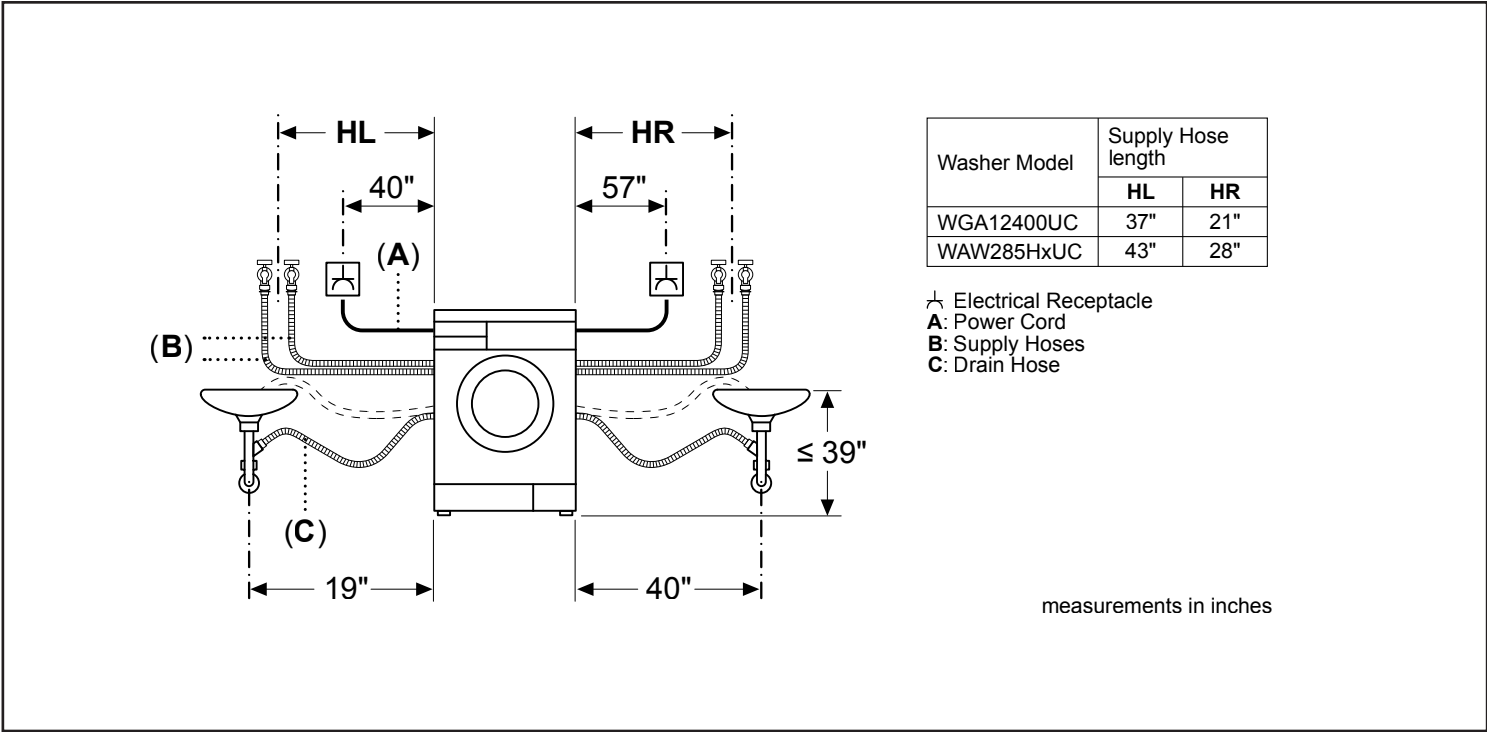
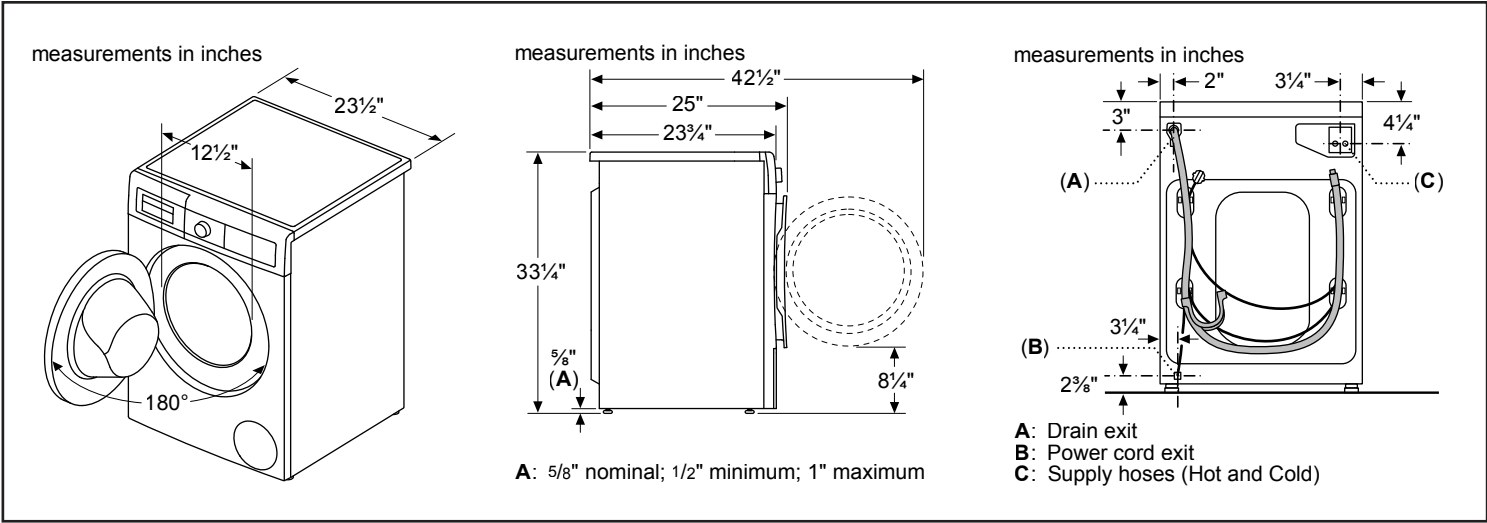

**Accessories:** To purchase Bosch accessories, cleaners & parts please visit [www.bosch-home.com/us/store](http://www.bosch-home.com/us/store) or call 1-800-944-2904 (Mon to Fri 5 am to 6 pm PST, Sat 6 am to 3 pm PST).

**Notes:** All height, width and depth dimensions are shown in inches. BSH reserves the absolute and unrestricted right to change product materials and specifications, at any time, without notice. Consult the product's installation instructions for final dimensional data and other details prior to making cutout.

**Warranties:** Please see Use & Care manual or Bosch website for statement of limited warranty.

**For more information on our entire line of products, go to [www.bosch-home.com/us](http://www.bosch-home.com/us) or call 1-800-944-2904**

© BSH Home Appliances Corporation. All rights reserved. Bosch is a registered trademark of Robert Bosch GmbH.

11/23

# 24" Compact Washer

500 Series Washer with Home Connect® – WAW285H1UC



**BOSCH**  
Invented for life

## Installation Details

Reach of Power cords + Adapter (Not to Scale)

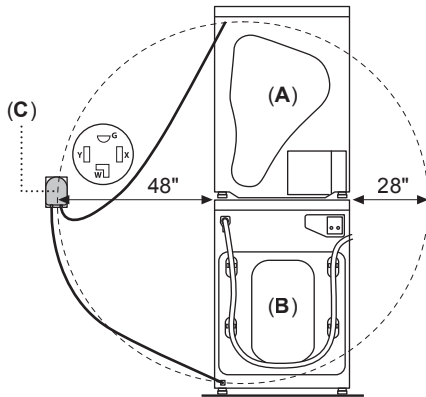

A: Dryer  
B: Washer  
C: Power Adapter  
All references to NEMA 14-30R  
Dryer receptacles in this document  
have the orientation with the  
ground pin up.

Use of two individual NEMA 6-15R or  
6-20R receptacles may be used  
as alternative means to power  
Washer and Dryer.

Dimensions reflect use of stacking kits.

## Optional Pedestal

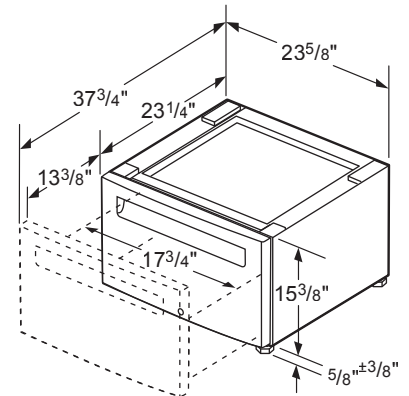

Guidance for location of Dryer receptacle  
and Water taps to minimize depth  
allowance (Not to Scale)

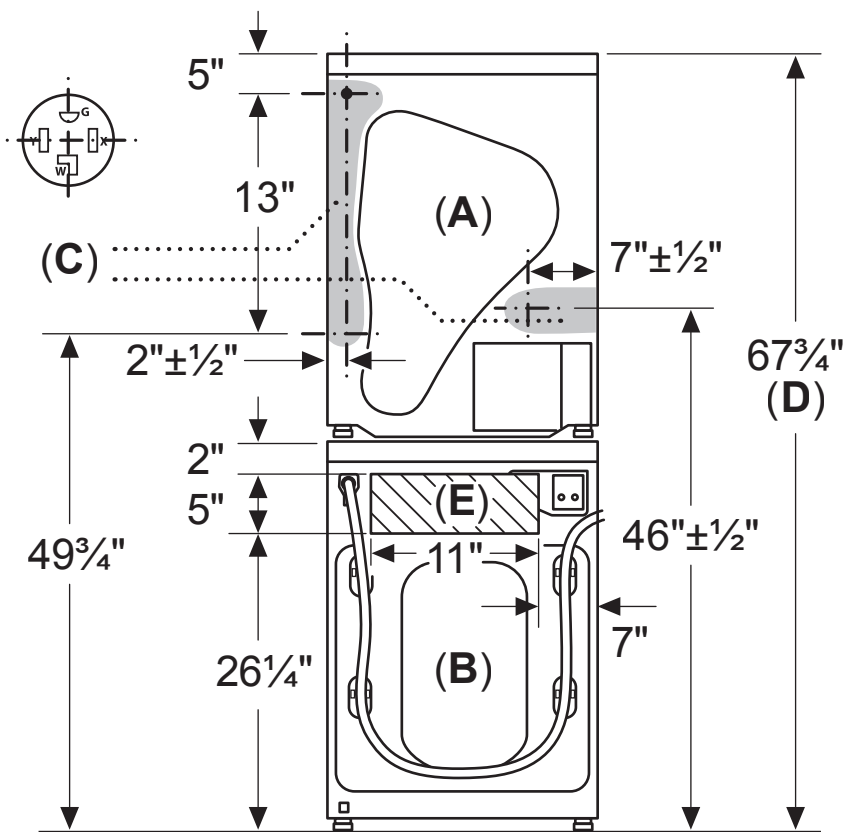

A: Dryer  
B: Washer  
C: Axis lines, in shaded areas, indicate Center  
Line of home's Dryer receptacle for minimal  
depth allowance if located entirely behind  
appliances.  
D: Minimum Stack Height (with Stacking Kit)  
E: Hatched area - indicates location for  
home's Hot and Cold water taps/outlets  
for minimal depth if located entirely behind  
appliances.

Installer / Customer is responsible for fit,  
function, maintenance and safety of utility  
installation.

measurements in inches

**Accessories:** To purchase Bosch accessories, cleaners & parts please visit [www.bosch-home.com/us/store](http://www.bosch-home.com/us/store) or call 1-800-944-2904 (Mon to Fri 5 am to 6 pm PST, Sat 6 am to 3 pm PST).

**Notes:** All height, width and depth dimensions are shown in inches. BSH reserves the absolute and unrestricted right to change product materials and specifications, at any time, without notice. Consult the product's installation instructions for final dimensional data and other details prior to making cutout.

**Warranties:** Please see Use & Care manual or Bosch website for statement of limited warranty.

**For more information on our entire line of products, go to [www.bosch-home.com/us](http://www.bosch-home.com/us) or call 1-800-944-2904**

© BSH Home Appliances Corporation. All rights reserved. Bosch is a registered trademark of Robert Bosch GmbH.

# 24" Compact Washer

500 Series Washer with Home Connect® – WAW285H1UC



**BOSCH**  
Invented for life

## Installation Details

Closet: Stacked Washer and Condensing Dryer

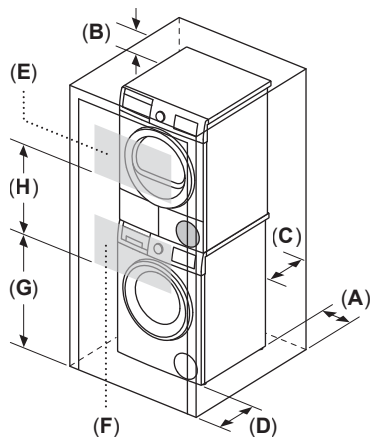

**Minimum clearance requirements**  
(Stacked, Stand Alone or Side by Side):

- A: Both sides (left and right) –  $\frac{5}{8}$ "
- B: Top –  $\frac{3}{4}$ "
- C: Rear –  $2\frac{1}{2}$ "
- D: Front –  $2\frac{1}{2}$ "

**Minimum louvered area and spacing:**

- E: Top louver area – 63 sq. in.
- F: Bottom louver area – 63 sq. in.
- G: Lower Height (stacked) – 37"
- H: Upper Height (stacked) – 26"
- J: Lower Height (stand alone) – 3"
- K: Upper Height (stand alone) – 29"

For shortest drying times keep closet door open while dryer is operating. When closet doors are closed, open areas only allow minimal drying results (expect long drying times).

Closet: Stand Alone (shown) or Side by Side

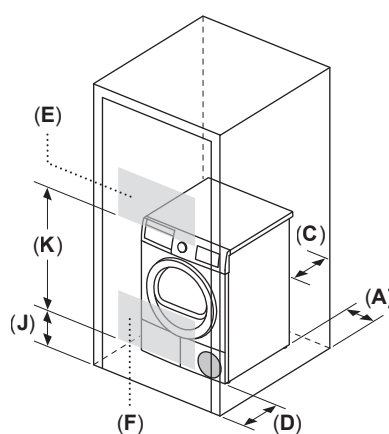

Closet: Stacked Washer with Heat Pump Dryer

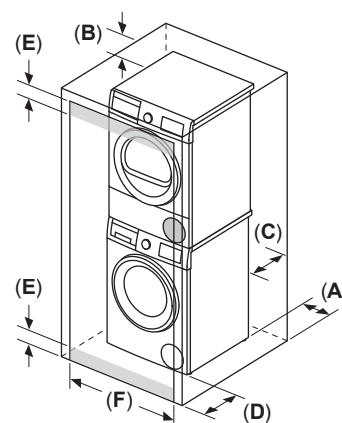

**Minimum clearance requirements**  
(Stacked, Stand Alone or Side by Side):

- A: Both sides (left and right) –  $\frac{1}{2}$ "
- B: Top –  $\frac{3}{4}$ "
- C: Rear – 3"
- D: Front –  $\frac{1}{2}$ "

**Minimum door undercut (louvered area):**

- E: Undercut height (Top and Bottom) –  $1\frac{1}{4}$ "  
Louvered areas of equal total sizes and split between upper and lower portions of door are permitted.
- F: Undercut width (Top and Bottom):  
– 24" minimum for Stacked and Stand Alone  
– 48" minimum for Side by Side

For shortest drying times keep closet door open while dryer is operating. When closet doors are closed, open areas only allow minimal drying results (expect long drying times).

Under Counter (Preferred)

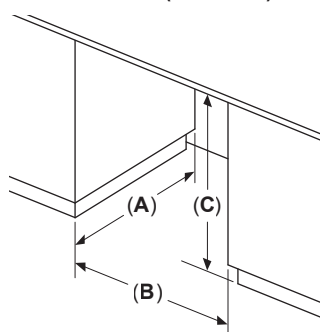

**Minimum opening dimensions:**

- A: Depth – 28"
- B: Width –  $23\frac{3}{8}$ "
- C: Height –  $34\frac{1}{2}$ "

Front of appliance fully open.  
No doors or coverings.

Under Counter Enclosed (Less Preferred)

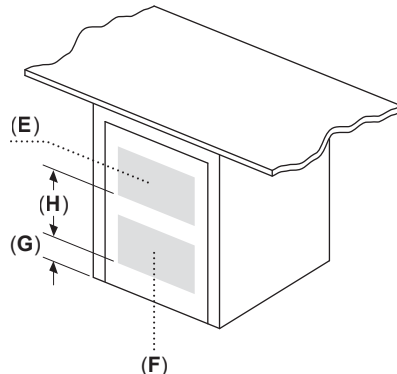

If the front of the appliance is covered, louvered openings must be installed as shown and front/rear clearances adhered to according to closet installations.

**Minimum louvered area and spacing:**

- E: Top louver area – 63 sq. in.
- F: Bottom louver area – 63 sq. in.
- G: Lower Height – 3"
- H: Upper Height – 14"

For shortest drying times keep cabinet door open while dryer is operating. When cabinet door is closed, open areas only allow minimal drying results (expect long drying times).

measurements in inches

**Accessories:** To purchase Bosch accessories, cleaners & parts please visit [www.bosch-home.com/us/store](http://www.bosch-home.com/us/store) or call 1-800-944-2904 (Mon to Fri 5 am to 6 pm PST, Sat 6 am to 3 pm PST).

**Notes:** All height, width and depth dimensions are shown in inches. BSH reserves the absolute and unrestricted right to change product materials and specifications, at any time, without notice. Consult the product's installation instructions for final dimensional data and other details prior to making cutout.

**Warranties:** Please see Use & Care manual or Bosch website for statement of limited warranty.

**For more information on our entire line of products, go to [www.bosch-home.com/us](http://www.bosch-home.com/us) or call 1-800-944-2904**

© BSH Home Appliances Corporation. All rights reserved. Bosch is a registered trademark of Robert Bosch GmbH.