

en Assembly instructions
please keep

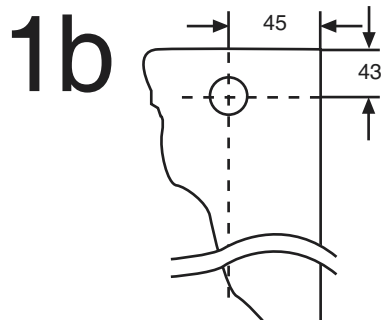

1a

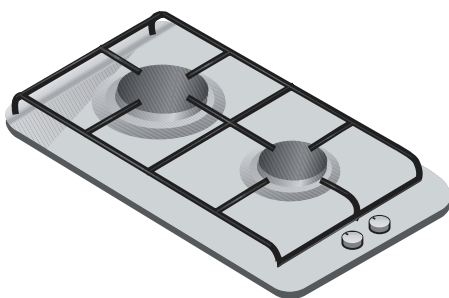
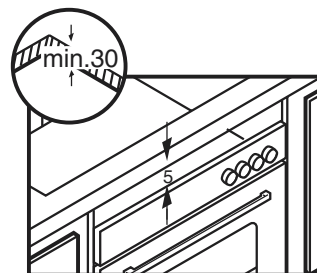
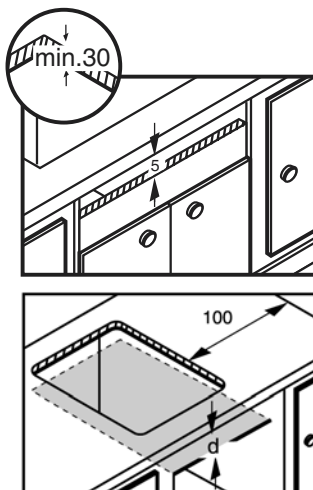
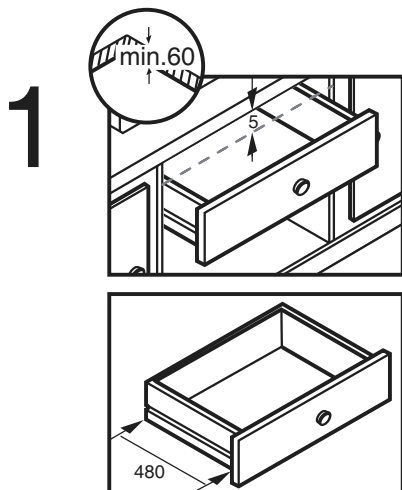
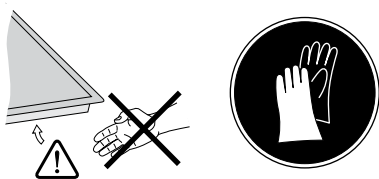
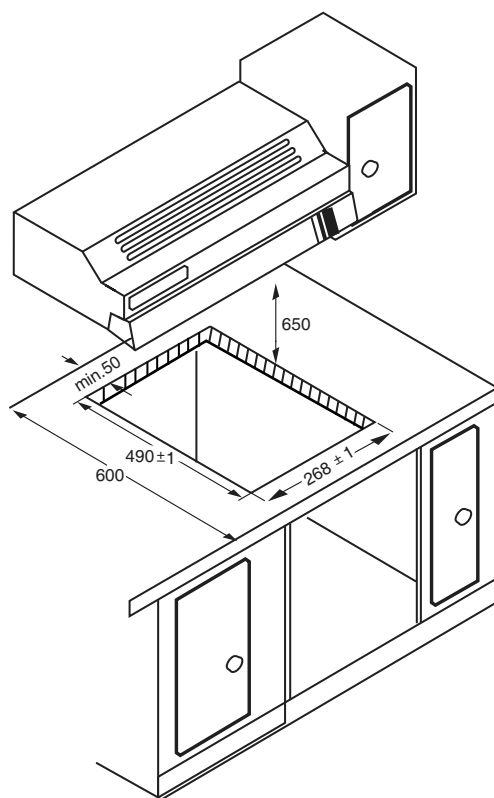
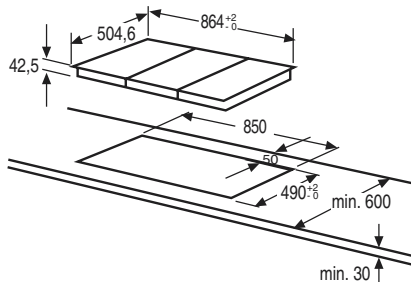
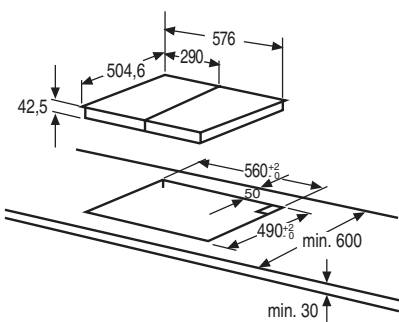
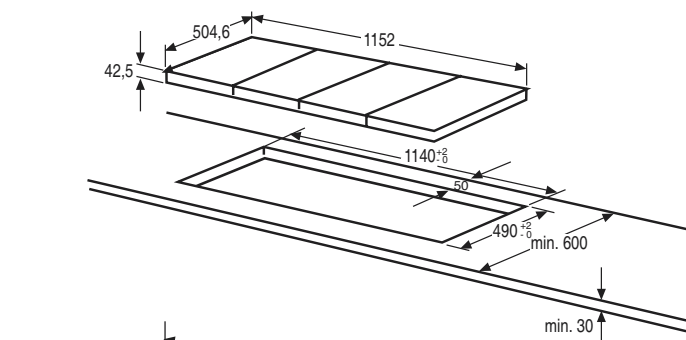

2a

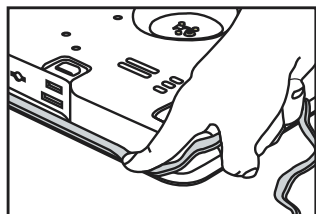

2b

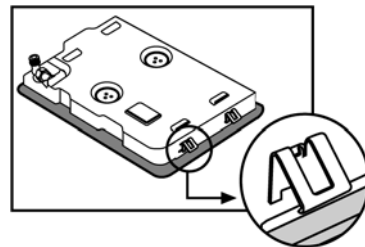

2c

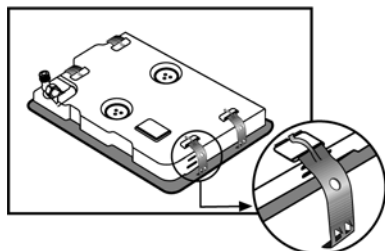

2d

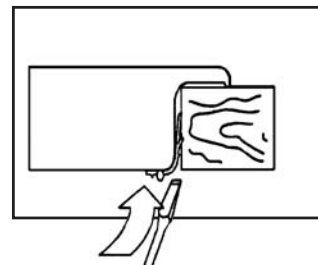

3

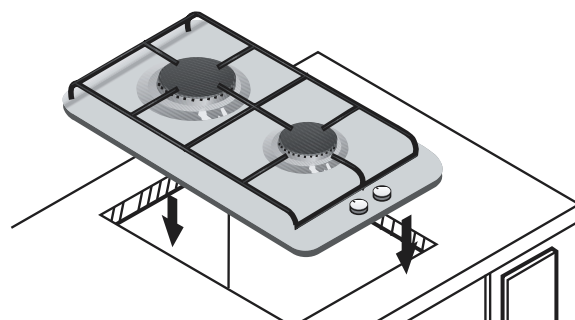
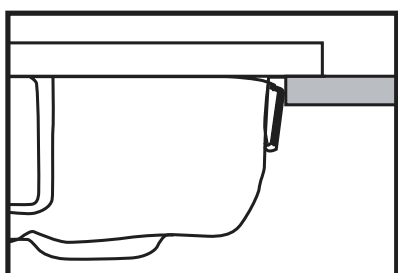

4a

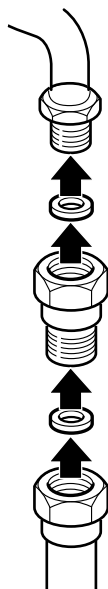

4b

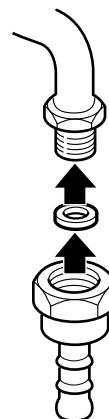

5

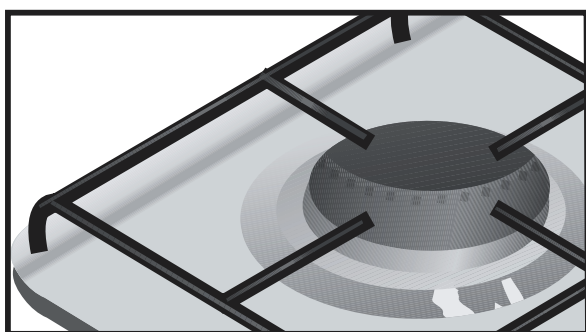

6

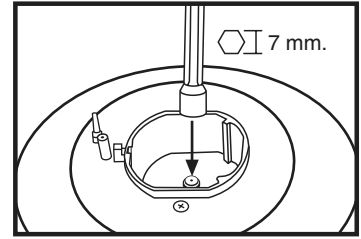
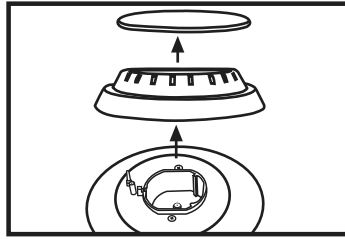
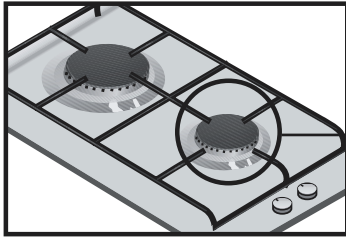

7

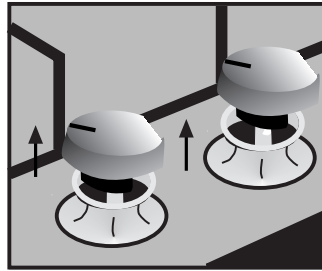
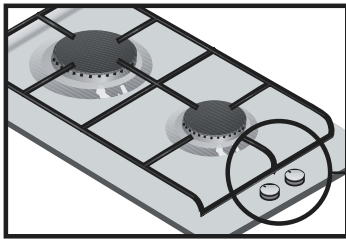

8

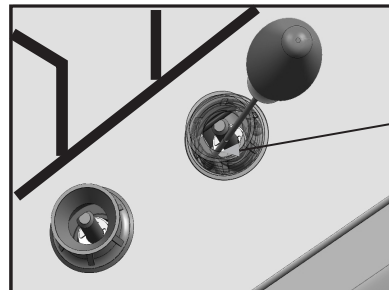
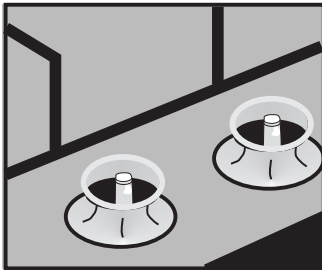

9

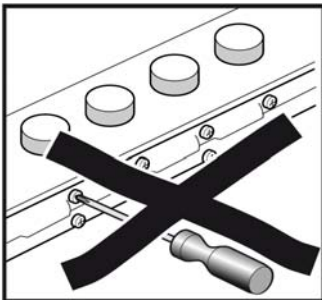

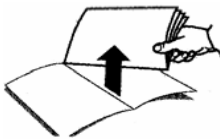

Please detach and keep

en

Instructions for the installation technician

All installation, regulation and adaptation to other types of gas must be carried out by an authorised installation technician, respecting all applicable regulations, standards and the country's electrical and gas supply companies' specifications. It is recommended that you call our Technical Assistance Service for adaptation to other types of gas. Before you begin, turn off the appliance's electricity and gas supply.

This appliance has been designed for home use only, not for commercial or professional use. This appliance cannot be installed on yachts or in caravans. The warranty will only be valid if the appliance is used for the purpose for which it was designed. Before connecting up the appliance to the installation, first check that it has been adjusted for the type of gas with which it is to be supplied.

Our cooking hobs leave the factory designed to function with the type of gas that is indicated on the specifications plate.

It is of the utmost importance that the place in which the appliance is installed has suitable **ventilation in accordance with regulations** so that the combustion gases are piped outside.

Check the dimensions of the cooking hob as well as the dimensions of the hole to be cut in the kitchen unit. The panels located above the work surface, right next to the cooking hob, must be made of **non-flammable material**. Both the stratified surfacing and the glue used to secure it should be heat resistant, to prevent deterioration.

No electrical cables should come into contact with hot areas.

The power cable must be secured to the furniture module to prevent it from touching any hot parts of the oven or the cooking hob.

All appliances containing any electrical components must be **earthed**.

Handle the appliance with care during the entire installation process. **Do not hit the appliance against anything. In the event that this advice is not followed, the installation technician will be responsible for any damage caused, and the manufacturer will be exempt from all responsibility.**

Installing the cooking hob in the furniture module

The option of locating the hob in a kitchen unit (in accordance with gas appliances regulation EN 30 - 1- 1) is Type 3.

Fitting measurements

Note: Wear protective gloves to fit the hob.

1 - Minimum distances (mm). Cut an aperture of the necessary dimensions in the work surface. Fig. 1.

In the event that no oven is to be installed beneath the cooking hob, we recommend fitting a separator which will block off access to the underside of the cooking surface.

All gas $d < 150$

Electrical hob $10 < d < 150$

If the cooking hob is to be installed above an oven, check that the oven is fitted with power ventilation, and check the dimensions according to the assembly manual.

Place the cooking hob in the insertion aperture cut into the furniture module.

2 - The wood fibres that have been used to make the cooking hob modules tend to swell quite quickly when they come into contact with moisture. We therefore recommend that the cut edges are treated with a special glue to protect them from steam or any condensation that might drip down beneath the work surface of the cooker unit.

Depending on the model, the clips and the watertight seal (underside of the cooking hob) under any circumstance remove them. The seal ensures that the entire work surface will be watertight, and prevents water seepage. The seal is to be placed on the edge of the interior housing and should protrude approximately 3 mm.

If this item has not been fitted in the factory, remove the pan supports and the gas burner covers and diffusers from your cooking hob, and turn it upside down. Now fit the adhesive seal supplied with the appliance onto the lower edge of the cooking hob (see Fig. 2a), remove the staples from the attached accessories bag and secure them into the lateral orifices that are provided for this purpose. Fig. 2b or 2c.

3 - Press down all around the edges so that the cooking hob is supported along its entire perimeter, Fig. 3.

If you should need to dismantle the appliance, simply push it upwards from underneath (with staple type 2b).

If your cooking hob has the type of staple shown in Fig. 2c, you will have to lever it up with a screwdriver to dismantle it. Fig. 2d.

4 - On gas hobs, the end of the gas intake comes with $\frac{1}{2}$ " (20,955 mm) thread.

This thread ensures:

- A rigid connection.
- Connection using a flexible tube (L min. 1 m - max. 3 m).
- Connection using a rubber pipe (L min. 0.4 m - max. 1.5 m). In this case, insert the accessory supplied or available from the technical assistance service (code 066950) at the end of the connection. Fig. 4b.

With this option, you must prevent the pipe from coming into contact with moving parts of the insertion unit (for example, a drawer) or access to any spaces which might become obstructed or to any hot surfaces. Insert the accessory (code 427924) and the watertight seal (code 034308) supplied or available from the technical assistance service between the

manifold outlet and the gas supply.

Fig. 4a.

The position of the gas pipe, relative to the hole in the kitchen unit where it is to be fitted is shown in Fig. 1b.

Make sure that all the connections that have been installed are airtight. The manufacturer declines any responsibility for leaks or for any connections installed by the installation technician.

5 - The following must be checked on the specifications plate: the voltage and the total power. **This appliance must be earthed.**

Always make certain that all connections that have been installed are in accordance with national legal requirements. Observe all the requirements of the local electrical supply company.

In order to meet standard safety regulations, the installation technician must provide an omnipolar cut-off switch with a contact separation of at least 3 mm. This is not necessary if the connection is made via a plug, so long as the user has access to it.

All appliances fitted with plugs should only be connected up to sockets which have been correctly earthed.

This appliance is type "Y", which means that the input cable **MUST NOT BE CHANGED BY THE USER**; only by the service technician for that particular make. The section and type of cable must be observed.

Do not make any adjustments in the interior of the appliance. If this should be necessary, call our technical assistance service.

Our cooking hobs are provided with a power cable with or without a plug.

Types of cables:

Cooking hob:	Power cable:
All gas	3 x 0,75 mm ²
Electrical hob	3 x 1,5 mm ²

6 - To complete the installation, the burner diffusers and covers must be fitted onto their corresponding rings. In addition, the pan supports must also be located in their correct places.

Fig. 5. Modular hobs may be combined with the appliance using the joint accessory NEZ34VLA. Fig. 1a. If a ceramic hob is to be combined with the appliance, the correct joint accessory to use is NEZ34VLB; these are available from our technical service.

Changing gas type

All installation, regulation and adaptation to other types of gas must be carried out by an authorised installation technician, respecting all applicable regulations, standards and the country's electrical and gas supply companies' specifications. It is recommended that you call our Technical Assistance Service for adaptation to other types of gas. Before you begin, turn off the appliance's electricity and gas supply.

Provided that national laws so permit, this cooking hob may be adapted to function with other types of gas. To do so, all the following steps should be carried out.

A) Change the nozzles of the burners on the cooking hob.





- 1- Remove the pan supports, covers and the main body of the burner.
 - 2- Change the burner tips using a 7 mm (see table I) socket spanner and make sure that they are tightened all the way in order to ensure that they are correctly sealed. Fig. 6.
- With these burners the air does not have to be adjusted.

B) Adjust the burner taps for reduced consumption

- 1- Turn the taps down to minimum.
- 2- Remove the control knobs from the taps. Fig. 7.
- 3- It has a flexible rubber seal. Simply apply pressure with the tip of the screwdriver to release the thread toward the tap's adjusting screw. Fig. 8. **Do not remove the grip.**
- 4 - Adjusting the by-pass screw.
 - For propane and butane gas, the screw must be screwed down tight.
 - For natural gas, turn the screw (to the left) until the burner is producing the desired gas flow, in such a way that when you turn the burner controls from maximum to minimum, the flame does not go out, nor is there a flame back draught created.
- 5- It is important to make sure that all the seals are in place in order to ensure that, in the case of spillages on the hob, there are no short circuits.
- 6- Replace the control knobs on the taps.

Do not dismantle the tap shaft (Fig. 9): in the event of a malfunction, change the whole tap.

C) Place the sticker indicating that the appliance's gas supply has been changed next to the specifications plate.

	GAS	mbar		Qn (Kw)	
	LPG	29	50	1,00	27
	TG	10	143	1,20	27
	LPG	29	85	3,00	39
	TG	10	280	3,40	39
	LPG	29	97	3,60	53
	TG	10	325	3,80	00

		LPG/29	TG/10
	LPG/29		C
	TG/10	C	

