



**MUM57860AU**  
**Home Professional**



**BOSCH**

**en** Operating instructions

*Congratulations on the purchase of your new BOSCH appliance.  
In doing so, you have opted for a modern, high-quality domestic appliance.  
You can find further information about our products on our web page.*

## Contents

|                                   |    |
|-----------------------------------|----|
| For your safety . . . . .         | 2  |
| Overview . . . . .                | 5  |
| Operating the appliance . . . . . | 6  |
| Cleaning and servicing . . . . .  | 9  |
| Storage . . . . .                 | 10 |
| Troubleshooting . . . . .         | 10 |
| Application examples . . . . .    | 11 |
| Disposal . . . . .                | 12 |
| Warranty conditions . . . . .     | 12 |
| Optional accessories . . . . .    | 13 |

## For your safety

**Before use, read these instructions carefully in order to become familiar with important safety and operating instructions for this appliance.**

If the instructions for correct use of the appliance are not observed, the manufacturer's liability for any resulting damage will be excluded. This appliance is designed for processing normal household quantities in the home or similar quantities in non-industrial applications.

Non-industrial applications include e.g. use in employee kitchens in shops, offices, agricultural and other commercial businesses, as well as use by guests in boarding houses, small hotels and similar dwellings.

Use the appliance for processing normal quantities of food for domestic use. Do not exceed permitted maximum quantities (see "Application examples").

This appliance is suitable for mixing, kneading and beating food. It must not be used for processing other objects or substances. Other applications are possible if the accessories approved by the manufacturer are used.

Use the appliance with original accessories only. When using the accessories, follow the enclosed operating instructions.

Please keep the operating instructions in a safe place. If passing on the appliance to a third party, always include the operating instructions.

## General safety instructions

### Electric shock risk

The appliance must not be used by children.

The appliance and its power cord must be kept away from children.

Appliances can be used by persons with reduced physical, sensory or mental capabilities or lack of experience and knowledge if they have been given supervision or instruction concerning use of the appliance in a safe way and if they understand the hazards involved.

Children shall not play with the appliance.

Cleaning and user maintenance shall not be made by children without supervision.

Connect and operate the appliance only in accordance with the specifications on the rating plate. Do not use the appliance if the power cord and/or appliance are damaged.

Always disconnect the appliance from the supply if it is left unattended and before assembling, disassembling or cleaning.

Do not place the power cord over sharp edges or hot surfaces.

To prevent injury, a damaged power cord must be replaced by the manufacturer or his customer service or a similarly qualified person.

Only our customer service may repair the appliance.

---

## Safety instructions for this appliance

---

### **Risk of injury**

#### **Risk of electric shock!**

Do not insert mains plug until all preparations for working with the appliance are complete.

Never immerse the base unit in liquid or hold under running water.

Do not use a steam cleaner.

Do not adjust the swivel arm while the appliance is switched on.

Wait until the drive has come to a standstill.

Do not change tool/accessory until the drive is at a standstill – when the appliance is switched off, the drive continues running briefly.

Use only the rotary switch to switch the appliance on or off.

When the appliance is not in use, pull out the mains plug.

Before eliminating a fault, pull out the mains plug.

#### **Risk of injury from the rotating tools!**

While the appliance is operating, never place fingers in the mixing bowl.

Attach the cover (12) before operating the appliance!

Do not change tools until the drive has come to a standstill – when the appliance is switched off, the drive continues running briefly and stops in the tool change position. Do not move the swivel arm until the tool has come to a standstill.

For reasons of safety the appliance cannot be operated unless unused drives are covered with drive guards (5, 8).

Before attaching/removing the continuous-feed shredder, wait until the drive has come to a standstill and pull out the mains plug.

Do not reach into the feed tube.

### Risk of injury from sharp blades!

Do not grip the sharp blades or edges of the cutting discs.

Take hold of cutting discs by the edge only.

Do not touch blender blades with bare hands.

### Risk of injury from sharp blades/rotating drive!

Never place fingers in the attached blender! Do not remove/attach the blender until the drive is at a standstill! Operate the assembled blender only and with the lid attached.

### Risk of scalding!

If processing hot liquids, steam escapes through the funnel in the lid.

Add a max. 0.5 litres of hot or frothing liquid.

### Important!

Use the appliance with original accessories only.

When using the accessories, follow the enclosed operating instructions.

Use only one tool or accessory at any one time.

## ▲ Explanation of the symbols on the appliance or accessory



Follow the instructions in the operating instructions.



Caution! Rotating blades.



Caution! Rotating tools.

Do not place fingers in the feed tube.

## Safety systems

### Start lock-out

See “Operating positions” table.

The appliance can be switched on in **pos. 1 and 3** only:

- when the bowl (11) has been inserted and turned until it locks into place and
- the blender drive cover has been attached (8).

### Restart lock-out

If the power is interrupted, the appliance remains switched on but the motor does not start running again when the power is restored. To switch the appliance on again, turn the rotary switch to **0/off**, then switch on.

## Overload protection

If the motor switches itself off while the appliance is being used, the overload protection feature has been activated.

A possible cause may be that too much food was processed at one time.

**If a safety system is activated, see “Troubleshooting”.**

The operating instructions describe several models, see also overview of models (Fig. M). The appliance requires no maintenance.

## Overview

Please fold out the illustrated pages.

Fig. A

### Base unit

- 1 Release button**
  - 2 Swivel arm**  
“Easy ArmLift” function to support the upward movement of the arm (see “Work positions”).
  - 3 Rotary switch**  
When the appliance has been switched off (position **0/off**), the appliance runs automatically to the optimum position for changing the tools.  
**0/off** = Stop  
**M** = Instantaneous switching at maximum speed, hold switch for required blending duration.  
Settings **1–7**, Operating speed:  
**1** = low speed – slow,  
**7** = high speed – fast.
  - 4 Operating indicator**  
Is lit while the appliance is operating (rotary switch on **M** or **1–7**).  
Flashes if the appliance has been operated incorrectly, the electronic fuse has tripped or the appliance is defective – see section “Troubleshooting”.
  - 5 Drive cover**  
To remove the drive cover, press on the rear area and remove cover.
  - 6 Drive for**  
– continuous-feed shredder and  
– citrus press (optional accessory \*).  
When not in use, attach the drive cover.
  - 7 Drive for tools (stirrer, whisk, kneading hook) and mincer (optional accessory \*)**
  - 8 Blender drive cover**
  - 9 Drive for blender (optional accessory \*)**  
When not in use, attach the blender drive cover.
  - 10 Automatic cord winder**
- ### Bowl with accessories
- 11 Stainless steel stirring bowl**
  - 12 Lid**

### Tools

- 13 Professional flexi stirring whisk**
  - 14 Professional beating whisk**
  - 15 Kneading hook with dough deflector**
  - 16 Accessories bag**  
For storage of the tools and cutting discs.
- ### Continuous-feed shredder
- 17 Pusher**
  - 18 Cover with filling shaft**
  - 19 Cutting discs**
    - 19a** Professional Supercut reversible disc – coarse/fine
    - 19b** Grating disc – coarse \*
    - 19c** Asian vegetable disc \*
  - 20 Disc holder**
  - 21 Housing with outlet opening**
- ### Blender \*
- 22 Blender jug**
  - 23 Lid**
  - 24 Funnel**

\* If an accessory is not included in the product package, it can be purchased via the trade or customer service.

## Operating positions

Fig. 13

### ⚠ Attention!

Before operating the appliance, attach the tool/accessory to the correct drive and in the correct position and place in the operating position according to this table.

The swivel arm must be engaged in every operating position.



### Note:

The swivel arm features an "Easy Armlift" function which supports the upwards movement of the swivel arm.

### Selecting the operating position:

- Press the Release button and move the swivel arm.  
Support movement with your hand.
- Move the swivel arm until it engages in the required position.

| Position | Drive | Tool/Accessory | Operating speed |
|----------|-------|----------------|-----------------|
| 1        | 7     |                | 1-5             |
|          |       |                | 1-7             |
|          |       |                | 1-3             |
| 2        | 7     | *              | -               |
| 3        | 6     |                | 3-7             |
|          |       |                | 3-5             |
| 4        | 9     |                | 5-7             |
|          | 7     |                | 5-7             |

\* Insert/remove whisk, stirrer or kneading hook. Add large quantities of ingredients.

## Operation



### Risk of injury!

Do not insert mains plug until all preparations for working with the appliance are complete.



### Attention!

Do not operate the appliance without an accessory/tool in the operating position.

Do not operate the appliance empty.

Do not expose appliance or accessories to heat sources. Parts are not microwave-safe.

- Before operating the appliance and accessories for the first time, clean thoroughly; see "Cleaning and servicing".



### Important information

These operating instructions contain a sticker with reference values for the operating speed of the appliance when using the tools or accessories.

We recommend attaching this sticker to the appliance (Fig. 14).

## Preparation

- Place the base unit on a smooth, clean surface.
- Pull out the power cord (Fig. 15).  
Cord store: Pull out cable to the required length.



### Warning!

Do not twist the cord when inserting it.

If the appliance features an automatic cord winder, do not insert the cord manually.

If the cord jams, pull out the cord all the way and then allow it to wind up.

- Insert the mains plug.

## Bowl and tools



### Risk of injury from rotating tools

While the appliance is operating, never place fingers in the mixing bowl. Attach the cover (12) before operating the appliance!

Do not change tools until the drive has come to a standstill – when the appliance is switched off, the drive continues running briefly and stops in the tool change position. Do not move the swivel arm until the tool has come to a standstill.

For reasons of safety the appliance may only be operated when unused drives have been covered with drive guards (5, 8).



### Attention!

Use bowl with this appliance only.

### Professional flexi stirring whisk (13)

for stirring dough, e.g. cake mixture



### Professional beating whisk (14)

for whisking egg whites, cream and light dough, e.g. sponge mixture



### Kneading hook (15)

for kneading heavy dough and mixing-in ingredients that ought not be cut (e.g. raisins and chocolate chips)



## Important information concerning the use of the whisk

Fig. 13

The whisk should almost touch the bottom of the bowl to ensure that the ingredients are optimally mixed. If not, adjust the height of the whisk as follows:

- Remove mains plug.
- Press the Release button and move the swivel arm to position 2.
- Insert the whisk into the drive until the whisk locks into position.
- Hold whisk in place and loosen nut clockwise using open-ended wrench (size 8).
- Set the whisk to the optimum height by rotating the whisk:

- Turn clockwise: Raise
- Turn anti-clockwise: Lower

- Press the Release button and move the swivel arm to position 1.

Check the height of the whisk and, if required, correct.



- When the height has been set correctly, press Release button and move the swivel arm to position 2.
- Hold whisk in place and tighten nut anti-clockwise using open-ended wrench (size 8).



## Working with the bowl and the tools

Fig. 14

- Press the Release button and move the swivel arm to position 2.
- Insert the bowl:
  - Tilt the bowl forwards and then set it down.
  - Turn anti-clockwise until it locks into place.
- Depending on the processing task, insert the stirrer, whisk or kneading hook until it locks into position.



### Note:

If using the kneading hook, rotate the dough deflector until the kneading hook can lock into position (Fig. 13-4b).

- Put the ingredients to be processed into the bowl.
- Press the Release button and move the swivel arm to position 1.
- Attach the cover.
- Set the rotary switch to the desired setting.



### Our recommendation:

- Professional flexi stirring whisk: First mix at setting 1–2, then setting 3–5 as required
- Professional beating whisk: setting 7, mix in at setting 1
- Kneading hook: first stir in at setting 1, knead at setting 3

## Adding more ingredients

- Switch off the appliance with the rotary switch.
- Add more ingredients through the feed tube in the cover.
- or
- Remove lid.
- Press the Release button and move the swivel arm to position 2.
- Add ingredients.



## After using the appliance

- Switch off the appliance with the rotary switch.
- Remove mains plug.
- Remove lid.
- Press the Release button and move the swivel arm to position **2**.
- Take the tool out of the drive.
- Remove the bowl.
- Clean all parts, see "Cleaning and servicing".



## Continuous-feed shredder



### Risk of injury

*Do not grip the sharp blades or edges of the cutting discs. Take hold of cutting discs by the edge only.*

*Before attaching/removing the continuous-feed shredder, wait until the drive has come to a standstill and pull out the mains plug.*

*Do not reach into the feed tube.*

### Warning!

*The continuous-feed shredder must be completely assembled before use. Never assemble the continuous-feed shredder on the base unit.*

*Operate the continuous-feed shredder in the indicated operating position only.*

### Predetermined breaking point

The built-in predetermined breaking point protects the drive of the appliance. If an overload occurs, the drive shaft of the continuous-feed shredder breaks. However, the drive shaft can easily be replaced.

A new disc holder with drive shaft is available from customer service.

### Professional Supercut reversible disc – coarse/fine

for slicing fruit and vegetables. Process at setting 5.

Designation on the reversible slicing disc: "Grob" for the coarse cutting side  
"Fein" for the fine cutting side

### Warning!

*The reversible slicing disc is not suitable for slicing hard cheese, bread, rolls or chocolate. Slice boiled, waxy potatoes only when they are cold.*

## Grating disc – coarse

for grating raw potatoes, e.g. for potato pancakes or dumplings.

Process at setting 7.



## Asian vegetable disc

Slices fruit and vegetables into fine strips for Asian vegetable dishes.

Process at setting 5.



## Working with the continuous-feed shredder

**Fig. 8**

- Press the Release button and move the swivel arm to position **2**.
- Insert the bowl:
  - Tilt the bowl forwards and then set it down.
  - Turn anti-clockwise until it locks into place.
- Press the Release button and move the swivel arm to position **3**.
- Remove drive cover from the drive of the continuous-feed shredder (**Fig. 8-5a**).
- Hold disc holder at the lower end, ensuring that the two tips are face up.
- Carefully place the required slicing or shredding disc onto the tips of the disc holder (**Fig. 8-6a**). In the case of reversible discs, ensure that the required side is face up.
- Grip disc holder at the upper end and insert into the housing (**Fig. 8-6b**).
- Attach the cover (note mark) and turn all the way in a clockwise direction.
- Place continuous-feed shredder on the drive and rotate all the way in a clockwise direction, as illustrated in **Fig. 8-8**.
- Turn rotary switch to recommended setting.
- Put food to be processed in the feed tube and push down with the pusher.



### Warning!

*Prevent the cut ingredients from building up in the outlet opening.*

**Tip:** To ensure even cutting results, process thin ingredients in bunches.

**Note:** If the food to be processed sticks in the continuous-feed shredder, switch food processor off, pull out mains plug, wait until the drive comes to a standstill, remove cover from the continuous-feed shredder and empty feed tube.



## After using the appliance

- Switch off the appliance with the rotary switch.
- Rotate the continuous-feed shredder in an anti-clockwise direction and remove.
- Rotate the lid in an anti-clockwise direction and remove.
- Remove disc holder with disc. To do this, press finger from below against the drive shaft (Fig. 1).
- Clean parts.

## Blender



### **Risk of injury from sharp blades/rotating drive!**

*Never place fingers in the attached blender! Do not remove/attach the blender until the drive is at a standstill! Operate the assembled blender only and with the lid attached.*



### **Risk of scalding!**

*If processing hot liquids, steam escapes through the funnel in the lid. Add a max. 0.5 litres of hot or frothing liquid.*

### **Warning!**

*Blender may be damaged. Do not process deep-frozen ingredients (except ice cubes). Do not operate blender when empty.*

## Working with the blender

Fig. 8



- Press the release button and move the swivel arm to position 4.
- Remove the blender drive cover.
- Attach blender jug (mark on the handle on mark on the base unit) and turn all the way in an anti-clockwise direction.
- Add ingredients.  
Maximum capacity – liquid = 1.25 litres; maximum capacity frothing or hot liquids max. 0.5 litres; optimal processing capacity – solids = 50–100 g;
- Attach the cover and turn anti-clockwise all the way into the blender handle. The cover must be locked in position.
- Set the rotary switch to the desired setting.

## Adding more ingredients (Fig. 8-8)

- Switch off the appliance with the rotary switch.
- Remove the lid and add ingredients or
- remove the funnel and gradually add solid ingredients through the refill opening or
- pour liquid ingredients through the funnel.

## After using the appliance

- Switch off the appliance with the rotary switch.
- Rotate the blender in a clockwise direction and remove.

**Tip:** It is recommended to clean the blender immediately after use.

## Cleaning and servicing

### **Attention!**

*Do not use abrasive cleaning agents. Surfaces may be damaged.*

## Cleaning the base unit



### **Risk of electric shock!**

*Never immerse the base unit in water or place under running water. Do not use a steam cleaner.*

- Remove mains plug.
- Wipe the base unit and drive cover with a damp cloth. If required, use a little detergent.
- Then dry the base unit.

## Cleaning the bowl and tools

The bowl and tools are dishwasher-proof. Do not wedge plastic parts in the dishwasher, as they could be permanently deformed during the washing process!

## Cleaning the continuous-feed shredder

All parts of the continuous-feed shredder are dishwasher-proof.

**Tip:** To remove the red film after processing e.g. carrots, pour a little cooking oil on a cloth and rub the film off the continuous-feed shredder (not the cutting discs). Then rinse the continuous-feed shredder.

## Cleaning the blender



### **Risk of injury from sharp blades!**

*Do not touch blender blades with bare hands.*

The blender jug, lid and funnel are dishwasher-proof.

**Tip:** After processing liquids, it is often sufficient to clean the blender without removing it from the appliance. Pour a little water and washing-up liquid into the attached blender. Switch on the blender for several seconds (setting M). Pour out the water and rinse out the blender with clear water.



### **Important information**

If required, clean accessories bag. Follow care instructions in the bag.

## Storage



### **Risk of injury!**

*When the appliance is not in use, pull out the mains plug.*

### **Fig. 14**

- Store tools and cutting discs in the accessories bag.
- Keep accessories bag in the bowl.

## Troubleshooting



### **Risk of injury!**

*Before eliminating a fault, pull out the mains plug.*



### **Note:**

The Operating indicator flashes if the appliance has been operated incorrectly or the electronic fuse has tripped or the appliance is defective.

### **The swivel arm must be engaged in every operating position.**

Initially try to eliminate the problem which has occurred with the help of the following information.

## Troubleshooting

Appliance does not start.

### **Remedial action**

- Check the power supply.
- Check the mains plug.
- Check swivel arm. Correct position? Engaged?
- Screw on blender or bowl as far as possible.
- Attach the blender cover and screw on as far as possible.
- Attach drive cover to unused drives.
- The safety lock is active. Switch appliance to 0/off and then back to the required setting.

## Troubleshooting

Appliance switches off during use. The overload protection feature has been activated. Too much food was processed at one time.

### **Remedial action**

- Switch off the appliance.
- Reduce processing quantity. Do not exceed permitted maximum quantities (see "Application examples").

## Troubleshooting

While the drive was running, the release button was inadvertently pressed. The swivel arm moves up. The drive switches off, but does not stop in the tool change position.

### **Remedial action**

- Set the rotary switch to **0/off**.
  - Move swivel arm to position **1**.
  - Switch on appliance (setting 1).
  - Switch off appliance again.
- Tool stops in tool change position.



## Troubleshooting

Blender does not start working or stops during use, the drive is "humming". Blade is blocked.

### **Remedial action**

- Switch off the appliance and pull out the mains plug.
- Detach the blender and remove the obstruction.
- Re-attach the blender.
- Switch on the appliance.



### **Important information**

If the fault cannot be eliminated, please contact customer service.

## Application examples

### Whipped cream

100 g–600 g

- Whip cream with the whisk for 1½ to 4 minutes at setting 7 – depending on the quantity and properties of the cream.



### Egg white

1 to 8 egg whites

- Beat egg white with the whisk for 4 to 6 minutes at setting 7.



### Sponge mixture

*Basic recipe*

2 eggs

2–3 tbs. hot water

100 g sugar

1 packet of vanilla sugar

70 g flour

70 g cornflour

Baking powder if required

- Beat the ingredients (except flour and cornflour) with the whisk for approx. 4–6 minutes at setting 7 until frothy.
- Rotate switch to setting 1 and spoon in the sifted flour and cornflour within approx. ½ to 1 minute.



**Maximum quantity:** 2 x basic recipe

### Cake mixture

*Basic recipe*

3–4 eggs

200–250 g sugar

1 pinch of salt

1 packet of vanilla sugar or peel from ½ lemon

200–250 g butter or margarine (room temperature)

500 g flour

1 packet of baking powder

125 ml milk

- Mix all ingredients with the stirrer for approx. ½ minute at setting 1, then for approx. 3–4 minutes at setting 5.



**Maximum quantity:** 1.5 x basic recipe

### Short pastry

*Basic recipe*

125 g butter (room temperature)

100–125 g sugar

1 egg

1 pinch of salt

A little lemon peel or vanilla sugar

250 g flour

Baking powder if required

- Mix all ingredients with the stirrer for approx. ½ minute at setting 1, then for approx. 2–3 minutes at setting 3.

From 500 g flour:

- Knead the ingredients with the kneading hook for approx. ½ minute at setting 1, then for approx. 3–4 minutes at setting 3.



**Maximum quantity:** 2 x basic recipe

### Yeast dough

*Basic recipe*

500 g flour

1 egg

80 g fat (room temperature)

80 g sugar

200–250 ml lukewarm milk

25 g fresh yeast or 1 packet of dried yeast

Peel of ½ lemon

1 pinch of salt

- Mix all ingredients with the kneading hook for approx. ½ minute at setting 1, then for approx. 3–6 minutes at setting 3.



**Maximum quantity:** 1.5 x basic recipe

### Pasta dough

*Basic recipe*

300 g flour

3 eggs

1–2 tbs. (10–20 g) cold water as required

- Process all ingredients for approx. 3–5 minutes at setting 3 until a dough forms.

**Maximum quantity:** 1.5 x basic recipe



### Bread dough

*Basic recipe*

750 g flour

2 packets of dry yeast

2 tsp. salt

450–500 ml warm water

- Mix all ingredients with the kneading hook for approx. ½ minute at setting 1, then for approx. 4–5 minutes at setting 3.



## Mayonnaise

- 2 eggs
- 2 tsp. mustard
- ¼ l oil
- 2 tbs. lemon juice or vinegar
- 1 pinch of salt
- 1 pinch of sugar

Ingredients must be at the same temperature.

- Process the ingredients (except the oil) in the blender for several seconds at setting 3 or 4.
- Switch the blender to setting 7 and slowly pour the oil through the funnel and mix until the mayonnaise emulsifies.

**Eat the mayonnaise immediately, do not store.**

## Honey bread spread

- 30 g butter (from refrigerator, 7 °C)
- 190 g honey (from refrigerator, 7 °C)

- Cut butter into small pieces and put into the blender.
- Add honey and blend for 15 seconds at setting 7.



## Disposal



This appliance has been identified in accordance with the European directive 2012/19/EG on Waste Electrical and Electronic Equipment – WEEE.

The Directive paves the way for effective EU-wide withdrawal and utilization of waste appliances.

Please ask your dealer or inquire at your local authority about current means of disposal.

## Warranty conditions

The guarantee conditions for this appliance are as defined by our representative in the country in which it is sold. Details regarding these conditions can be obtained from the dealer from whom the appliance was purchased.

The bill of sale or receipt must be produced when making any claim under the terms of this guarantee.



## Optional accessories



**MUZ5ZP1**  
Citrus press

For squeezing oranges, lemons and grapefruits.



**MUZ5CC1**  
Dicer

For cutting fruit and vegetables into equally sized cubes

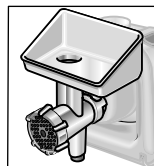

**MUZ5FW1**  
Mincer

For cutting fresh meat for steak tartare or meat loaf.

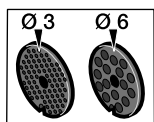

**MUZ45LS1**  
Perforated disc set fine (3 mm), coarse (6 mm)

For the mincer MUZ5FW1.  
Fine disc for pasties and spreads, coarse disc for sausages and bacon.

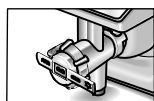

**MUZ45SV1**  
Viennese whirl attachment

For the mincer MUZ5FW1.  
With metal template for 4 different pastry moulds.

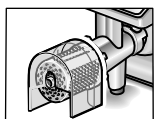

**MUZ45RV1**  
Grater attachment

For the mincer MUZ5FW1.  
For grating nuts, almonds, chocolate and dried bread rolls.

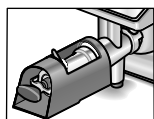

**MUZ45FV1**  
Juicer attachment

For the mincer MUZ5FW1.  
For pressing soft fruit, except raspberries, tomatoes and rose hips, to a pulp. At the same time e.g. currants are automatically stemmed and pitted.

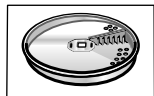





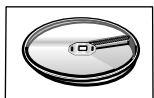

**MUZ45PS1**  
Chipper disc

For the continuous-feed shredder MUZ5DS1.  
For slicing raw potatoes for chips.



**MUZ45AG1**  
Asian vegetable disc

For the continuous-feed shredder MUZ5DS1.  
Slices fruit and vegetables into fine strips for Asian vegetable dishes.

|  |   |   |
|--|---|---|
|  | <b>MUZ45RS1</b><br>Grating disc coarse          | For the continuous-feed shredder MUZ5DS1.<br>For grating raw potatoes, e.g. for potato pancakes or dumplings.   |
|  | <b>MUZ45KP1</b><br>Potato fritter disc          | For the continuous-feed shredder MUZ5DS1.<br>For grating raw potatoes for rostis and potato fritters, for cutting fruit and vegetables into thick slices. |
|  | <b>MUZ5ER2</b><br>Stainless steel stirring bowl | Up to 750 g of flour plus ingredients can be processed in the bowl.   |
|  | <b>MUZ5KR1</b><br>Plastic mixing bowl           | Up to 750 g of flour plus ingredients can be processed in the bowl.   |
|  | <b>MUZ5MX1</b><br>Plastic blender attachment    | For blending drinks, for pureeing fruit and vegetables, for preparing mayonnaise, for cutting fruit, nuts, for crushing ice cubes.                        |
|  | <b>MUZ5MM1</b><br>Multi-mixer                   | For chopping herbs, vegetables, apples and meat, for shredding carrots, radishes and cheese, for grating nuts and cooled chocolate.                       |

If an accessory is not included in the product package, it can be purchased via the trade or from customer service.

## Kundendienst – Customer Service

### **DE Deutschland, Germany**

BSH Hausgeräte Service GmbH  
Zentralwerkstatt für kleine  
Hausgeräte  
Trautskirchener Strasse 6-8  
90431 Nürnberg  
Online Auftragsstatus, Filterbeutel-  
Konfigurator und viele weitere  
Infos unter:  
[www.bosch-home.de](http://www.bosch-home.de)

Reparaturservice, Ersatzteile &  
Zubehör, Produkt-Informationen:  
Tel.: 0911 70 440 040  
[mailto:cp-servicecenter@  
bshg.com](mailto:cp-servicecenter@bshg.com)  
Wir sind an 365 Tagen rund um die Uhr  
erreichbar.

### **AE United Arab Emirates,** الإمارات العربية المتحدة

BSH Home Appliances FZE  
Round About 13,  
Plot Nr MO-0532A  
Jebel Ali Free Zone – Dubai  
Tel.: 04 881 4401  
<mailto:service.uae@bshg.com>  
[www.bosch-home.com/ae](http://www.bosch-home.com/ae)

### **AL Republika e Shqiperise,** Albania

AERTECH SH.P.K.  
Rruga Qemal Stafa  
Pallati i ri perball Prokuroris se  
Pergjithshme  
Hyrja C Kati 10  
Tirana  
Tel.: 066 206 47 94  
<mailto:g.volina@aertech.al>

### **AT Österreich, Austria**

BSH Hausgeräte  
Gesellschaft mbH  
Werkskundendienst  
für Hausgeräte  
Quellenstrasse 2  
1100 Wien  
Tel.: 0810 550 511\*  
Fax: 01 605 75 51 212  
[mailto:vie-stoerungsannahme@  
bshg.com](mailto:vie-stoerungsannahme@bshg.com)  
Hotline für Espresso-Geräte:  
Tel.: 0810 700 400\*  
[www.bosch-home.at](http://www.bosch-home.at)  
\*innerhalb Österreichs zum Regionaltarif

### **AU Australia**

BSH Home Appliances Pty. Ltd.  
7-9 Arco Lane  
HEATHERTON, Victoria 3202  
Tel.: 1300 368 339  
<mailto:bshau-as@bshg.com>  
[www.bosch-home.com.au](http://www.bosch-home.com.au)

### **BA Bosna i Hercegovina,** Bosnia-Herzegovina

"HIGH" d.o.o.  
Gradačačka 29b  
71000 Sarajewo  
Info-Line: 061 100 905  
Fax: 033 213 513  
<mailto:delicnanda@hotmail.com>

### **BE Belgique, België, Belgium**

BSH Home Appliances S.A.  
Avenue du Laerbeek 74  
Laarbeeklaan 74  
1090 Bruxelles – Brussel  
Tel.: 070 222 141  
Fax: 024 757 291  
<mailto:bru-repairs@bshg.com>  
[www.bosch-home.be](http://www.bosch-home.be)

### **BG Bulgaria**

BSH Domakinski Uredi  
Bulgaria EOOD  
115K Tsarigradsko Chausse Blvd.  
European Trade Center Building,  
5th floor  
1784 Sofia  
Tel.: 02 892 90 47  
Fax: 02 878 79 72  
[mailto:informacia.servis-bg@  
bshg.com](mailto:informacia.servis-bg@bshg.com)  
[www.bosch.home.bg](http://www.bosch.home.bg)

### **BH Bahrain, مملكة البحرين**

Khalaifat Company  
Manama  
Tel.: 01 7400 553  
<mailto:service@khalaifat.com>

### **BY Belarus, Беларусь**

ООО "БСХ Бытовая техника"  
тел.: 495 737 2961  
<mailto:mok-kdhl@bshg.com>

### **CH Schweiz, Suisse,** Svizzera, Switzerland

BSH Hausgeräte AG  
Werkskundendienst für  
Hausgeräte  
Fahrweidstrasse 80  
8954 Geroldswil  
[mailto:ch-info.hausgeraete@  
bshg.com](mailto:ch-info.hausgeraete@bshg.com)  
Service Tel.: 0848 840 040  
Service Fax: 0848 840 041  
<mailto:ch-reparatur@bshg.com>  
Ersatzteile Tel.: 0848 880 080  
Ersatzteile Fax: 0848 880 081  
<mailto:ch-ersatzteil@bshg.com>  
[www.bosch-home.com/ch](http://www.bosch-home.com/ch)

### **CY Cyprus, Κύπρος**

BSH Ikiakes Syskeves-Service  
39, Arh. Makaariou III Str.  
2407 Egomi/Nikosia (Lefkosia)  
Tel.: 77 77 807  
Fax: 022 658 128  
[mailto:bsh.service.cyprus@  
cytanet.com.cy](mailto:bsh.service.cyprus@cytanet.com.cy)

### **CZ Česká Republika,** Czech Republic

BSH domácí spotřebiče s.r.o.  
Firemní servis domácích  
spotřebičů  
Pekařská 10b  
155 00 Praha 5  
Tel.: 0251 095 546  
Fax: 0251 095 549  
[www.bosch-home.com/cz](http://www.bosch-home.com/cz)

### **DK Danmark, Denmark**

BSH Hvidevarer A/S  
Telegrafvej 4  
2750 Ballerup  
Tel.: 44 89 89 85  
Fax: 44 89 89 86  
[mailto:BSH-Service.dk@  
bshg.com](mailto:BSH-Service.dk@bshg.com)  
[www.bosch-home.dk](http://www.bosch-home.dk)

### **EE Eesti, Estonia**

SIMSON OÜ  
Raua 55  
10152 Tallinn  
Tel.: 0627 8730  
Fax: 0627 8733  
<mailto:teenindus@simson.ee>

### **ES España, Spain**

BSH Electrodomésticos  
España S.A.  
Servicio Oficial del Fabricante  
Parque Empresarial PLAZA,  
C/ Manfredonia, 6  
50197 Zaragoza  
Tel.: 902 245 255  
Fax: 976 578 425  
<mailto:CAU-Bosch@bshg.com>  
[www.bosch-home.es](http://www.bosch-home.es)

### **FI Suomi, Finland**

BSH Kodinkoneet Oy  
Itälähdenkatu 18 A, PL 123  
00201 Helsinki  
Tel.: 0207 510 700  
Fax: 0207 510 780  
[mailto:Bosch-Service-  
FI@bshg.com](mailto:Bosch-Service-FI@bshg.com)  
[www.bosch-home.fi](http://www.bosch-home.fi)  
Lankapuhelimesta 8,28 snt/puhelu  
+ 7 snt/min (alv 23%)  
Matkapuhelimesta 8,28 snt/puhelu  
+ 17 snt/min (alv 23%)

**FR France**

BSH Electroménager S.A.S.  
50 rue Ardoin – BP 47  
93401 SAINT-OUEN cedex  
Service interventions à domicile:  
01 40 10 11 00

Service Consommateurs:  
0 892 698 010 (0,34 € TTC/mn)  
mailto:soa-bosch-conso@bshg.com  
Service Pièces Détachées et  
Accessoires:  
0 892 698 009 (0,34 € TTC/mn)  
www.bosch-home.fr

**GB Great Britain**

BSH Home Appliances Ltd.  
Grand Union House  
Old Wolverton Road  
Wolverton  
Milton Keynes MK12 5PT  
To arrange an engineer visit, to  
order spare parts and accessories  
or for product advice please visit  
www.bosch-home.co.uk  
or call  
Tel.: 0844 892 8979\*

\*Calls from a BT landline will be charged at  
up to 3 pence per minute. A call set-up fee  
of up to 6 pence may apply.

**GR Greece, Ελλάδα**

BSH Ikiakes Siskeves A.B.E.  
Central Branch Service  
17 km E.O. Athinon-Lamias &  
Potamou 20  
14564 Kifisia  
Πανελλήνιο τηλέφωνο: 181 82  
(αστική χρέωση)  
www.bosch-home.gr

**HK Hong Kong, 香港**

BSH Home Appliances Limited  
Unit 1 & 2, 3rd Floor  
North Block, Skyward House  
3 Sham Mong Road  
Tai Kok Tsui, Kowloon  
Hong Kong  
Tel.: 2565 6151  
Fax: 2565 6681  
mailto:bosch.hk.service@bshg.com  
www.bosch-home.cn

**HR Hrvatska, Croatia**

BSH kućni uređaji d.o.o.  
Kneza Branimira 22  
10000 Zagreb  
Tel.: 01 640 36 09  
Fax: 01 640 36 03  
mailto:informacije.servis-hr@  
bshg.com  
www.bosch-home.com/hr

**HU Magyarország, Hungary**

BSH Háztartási Készülék  
Kereskedelmi Kft.  
Háztartási gépek márkaszervize  
Királyhágó tér 8-9  
1126 Budapest  
Hibabejelentés  
Tel.: 01 489 5461  
Fax: 01 201 8786  
mailto:hibabejelentes@bsh.hu  
Alkatrészrendelés  
Tel.: 01 489 5463  
Fax: 01 201 8786  
mailto:alkatrészrendeles@bsh.hu  
www.bosch-home.com/hu

**IE Republic of Ireland**

BSH Home Appliances Ltd.  
Unit F4, Ballymount Drive  
Ballymount Industrial Estate  
Walkinstown  
Dublin 12  
Service Requests,  
Spares and Accessories  
Tel.: 01450 2655  
Fax: 01450 2520  
www.bosch-home.co.uk

**IL Israel, ישראל**

C/S/B Home Appliance Ltd.  
Ulief Building  
2, Hamelacha St.  
Industrial Park North  
71293 Lod  
Tel.: 08 9777 222  
Fax: 08 9777 245  
mailto:csb-serv@zahav.net.il  
www.bosch-home.co.il

**IN India, Bhārat, भारत**

BSH Customer Service Front Office  
Shop No.4, Everest Grande,  
Opp. Shanti Nagar Bus Stop,  
Mahakali Caves Road, Andheri East  
Mumbai 400093

**IS Iceland**

Smith & Norland hf.  
Noatuni 4  
105 Reykjavik  
Tel.: 0520 3000  
Fax: 0520 3011  
www.sminor.is

**IT Italia, Italy**

BSH Elettrodomestici S.p.A.  
Via. M. Nizzoli 1  
20147 Milano (MI)  
Numero verde 800 829 120  
mailto:info@bosch-elettrodomestici.it  
www.bosch-home.com/it

**KZ Kazakhstan, Қазақстан**

IP Turebekov Yerzhan  
Nurmanovich  
Jangeldina str. 15  
Shimkent 160018  
Tel.: 0252 31 00 06  
mailto:evrika\_kz@mail.ru

**LB Lebanon, لبنان**

Teheni, Hana & Co.  
Boulevard Dora 4043 Beyrouth  
P.O. Box 90449  
Jdeideh 1202 2040  
Tel.: 01 255 211  
mailto:Info@Teheni-Hana.com

**LT Lietuva, Lithuania**

Senuku prekybos centras UAB  
Jonavos g. 62  
44192 Kaunas  
Tel.: 0372 12146  
Fax: 0372 12165  
www.senukai.lt

**LU Luxembourg**

BSH électroménagers S.A.  
13-15 ZI Breedeweues  
1259 Senningerberg  
Tel.: 26349 300  
Fax: 26349 315  
mailto:lux-service.electromenager@  
bshg.com  
www.bosch-home.com/lu

**LV Latvija, Latvia**

General Serviss Limited  
Bullu street 70c  
1067 Riga  
Tel.: 07 42 41 37  
mailto:bt@olimpeks.lv

Elkor Serviss  
Brivibas gatve 201  
1039 Riga  
Tel.: 067 0705 20; -36  
Fax: 067 0705 24  
mailto:domoservice@elkor.lv  
www.servisacentrs.lv

**MD Moldova**

S.R.L. "Rialto-Studio"  
ул. Щусева 98  
2012 Кишинев  
тел./факс: 022 23 81 80  
mailto:bosch-md@mail.ru

**ME Crna Gora, Montenegro**

Elektronika komerc  
Ul. Slobode 17  
84000 Bijelo Polje  
Tel./Fax: 050 432 575  
Mobil: 069 324 812  
mailto:ekobosch.servis@  
t-com.me

**MK Macedonia, Македонија**

GORENEC  
Jane Sandanski 69 lok.3  
1000 Skopje  
Tel.: 022 454 600  
Mobil: 070 697 463  
mailto:gorenece@yahoo.com

**MT Malta**

Oxford House Ltd.  
Notabile Road  
Mriehel BKR 14  
Tel.: 021 442 334  
Fax: 021 488 656  
www.oxfordhouse.com.mt



**MV Raajjeyge Jumhooriyyaa, Maldives**

Lintel Investments  
Ma, Maadheli, Majeedhee Magu  
Malé  
Tel.: 0331 0742  
mailto:mohamed.zuhuree@  
lintel.com.mv

**NL Nederland, Netherlands**

BSH Huishoudapparaten B.V.  
Taurusavenue 36  
2132 LS Hoofddorp  
Storingsmelding:  
Tel.: 088 424 4010  
Fax: 088 424 4845  
mailto:bosch-contactcenter@  
bshg.com

Onderdelenverkoop:  
Tel.: 088 424 4010  
Fax: 088 424 4801  
mailto:bosch-onderdelen@bshg.com  
www.bosch-home.nl

**NO Norge, Norway**

BSH Husholdningsapparater A/S  
Grensesvingen 9  
0661 Oslo  
Tel.: 22 66 06 00  
Fax: 22 66 05 50  
mailto:Bosch-Service-NO@  
bshg.com  
www.bosch-home.no

**NZ New Zealand**

BSH Home Appliances Ltd.  
Unit F 2, 4 Orbit Drive  
Mairangi Bay  
Auckland 0632  
Tel.: 09 477 0492  
Fax: 09 477 2647  
mailto:bshnz-cs@bshg.com  
www.bosch-home.co.nz

**PL Polska, Poland**

BSH Sprzęt Gospodarstwa  
Domowego sp. z o.o.  
Al. Jerozolimskie 183  
02-222 Warszawa  
Centrala Serwisu  
Tel.: 801 191 534  
Fax: 022 572 7709  
mailto:Serwis.Fabryczny@bshg.com  
www.bosch-home.pl

**PT Portugal**

BSHP Electrodomésticos Lda.  
Rua Alto do Montijo, nº 15  
2790-012 Carnaxide  
Tel.: 707 500 545\*  
Fax: 214 250 701  
mailto:bosch.electrodomesticos.pt@  
bshg.com  
www.bosch-home.pt

\* (PT 0,10 €/min., Mobile 0,25 €/min)

**RO România, Romania**

BSH Electrocasnice srl.  
Sos. Bucuresti-Ploiesti,  
nr. 19-21, sect.1  
13682 Bucuresti  
Tel.: 021 203 9748  
Fax: 021 203 9733  
mailto:service.romania@bshg.com  
www.bosch-home.ro

**RU Russia, Россия**

ООО "БСХ Бытовая техника"  
Сервис от производителя  
Малая Калужская 19/1  
119071 Москва  
тел.: 495 737 2961  
mailto:mok-kdhl@bshg.com  
www.bosch-home.com

**SA Kingdom Saudi Arabia,**

المملكة العربية السعودية  
BSH Home Appliances  
Saudi Arabia L.L.C.  
Bin Hamran Commercial Centr.  
6th Floor 603B  
Jeddah 21481  
Tel.: 800 124 1247  
mailto:service.ksa@bshg.com  
www.bosch-home.com/sa

**SE Sverige, Sweden**

BSH Hushållsapparater AB  
Landsvägen 32  
169 29 Solna  
Tel.: 0771 11 22 77 local rate  
mailto:Bosch-Service-SE@  
bshg.com  
www.bosch-home.se

**SG Singapore, 新加坡**

BSH Home Appliances Pte. Ltd.  
37 Jalan Pemimpin  
Union Industrial Building  
Block A, #01-03  
577177 Singapore  
Tel.: 6751 5000  
Fax: 6751 5005  
mailto:bshsgp.service@bshg.com  
www.bosch-home.com.sg

**SI Slovenija, Slovenia**

BSH Hišni aparati d.o.o.  
Litostrojska 48  
1000 Ljubljana  
Tel.: 01 583 07 01  
Fax: 01 583 08 89  
mailto:informacije.servis@  
bshg.com  
www.bosch-home.com/si

**SK Slovensko, Slovakia**

BSH domácí spotřebiče s.r.o.  
Organizačná zložka Bratislava  
Galvaniho 17/C  
821 04 Bratislava  
Tel.: 02 44 45 20 41  
mailto:opravy@bshg.com  
www.bosch-home.com/sk

**TR Türkiye, Turkey**

BSH Ev Aletleri Sanayi  
ve Ticaret A.Ş.  
Fatih Sultan Mehmet Mahallesi  
Balkan Caddesi No: 51  
34771 Ümraniye, İstanbul  
Tel.: 0 216 444 6333\*  
Fax: 0 216 528 9188  
mailto:careline.turkey@bshg.com  
www.bosch-home.com/tr  
\*Çağrı merkezini sabit hatlardan aramanın  
bedeli şehir içi ücretlendirme. Cep  
telefonlarından ise kullanılan tarifeye göre  
değişkenlik göstermektedir

**TW Taiwan, 台灣**

Achelis Taiwan Co. Ltd.  
4th floor, No. 112 Sec 1  
Chung Hsiao E Road  
Taipei ROC 100  
Tel.: 02 2321 6222  
mailto:Bosch@achelis.com.tw

**UA Ukraine, Україна**

ТОВ "БСХ Побутова Техніка"  
тел.: 044 490 2095  
www.bosch-home.com.ua

**XK Kosovo**

NTP GAMA  
Rruga Mag Pristine-Ferizaj  
70000 Ferizaj  
Tel.: 0290 321 434  
Tel.: 00377 44 172 309  
mailto:a\_service@  
gama-electronics.com

**XS Srbija, Serbia**

BSH Kućni aparati d.o.o.  
Milutina Milankovića 11<sup>a</sup>  
11070 Novi Beograd  
Tel.: 011 205 23 97  
Fax: 011 205 23 89  
mailto:informacije.servis-sr@  
bshg.com  
www.bosch-home.rs

**ZA South Africa**

BSH Home Appliances (Pty) Ltd.  
15th Road Randjespark  
Private Bag X36, Randjespark  
1685 Midrand – Johannesburg  
Tel.: 086 002 6724  
Fax: 086 617 1780  
mailto:applianceserviceza@  
bshg.com  
www.bosch-home.com/za

**Robert Bosch Hausgeräte GmbH**

Carl-Wery-Str. 34

81739 München

Germany

**[www.bosch-home.com](http://www.bosch-home.com)**

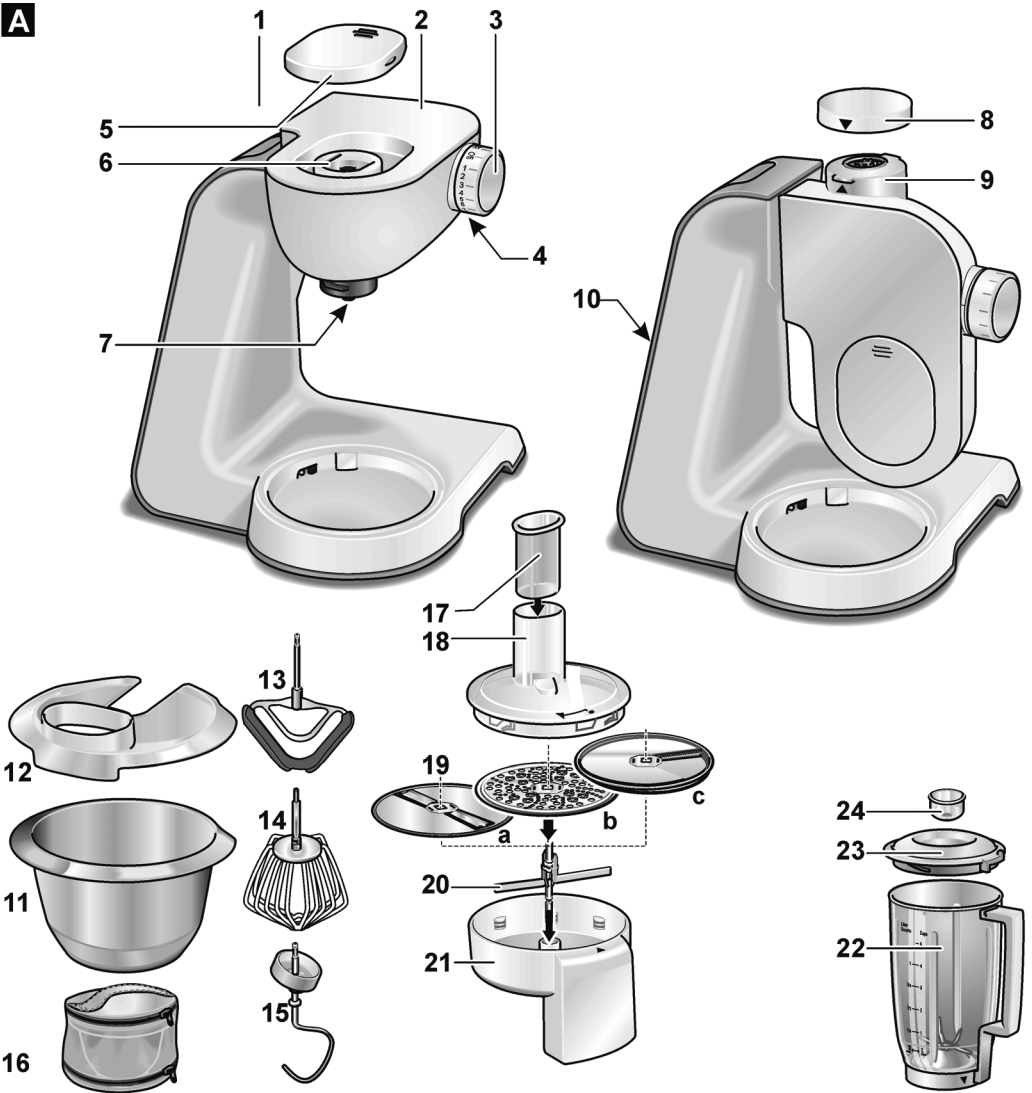
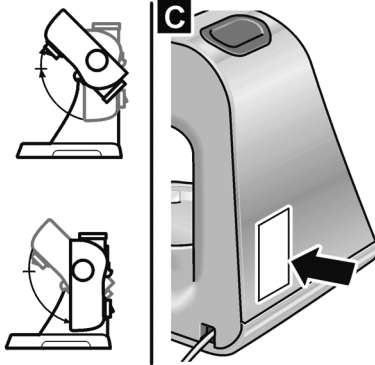
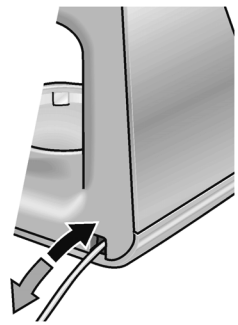
**A****B****C****D**

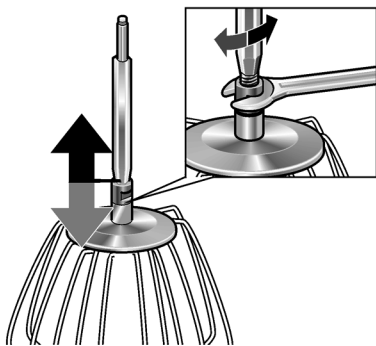
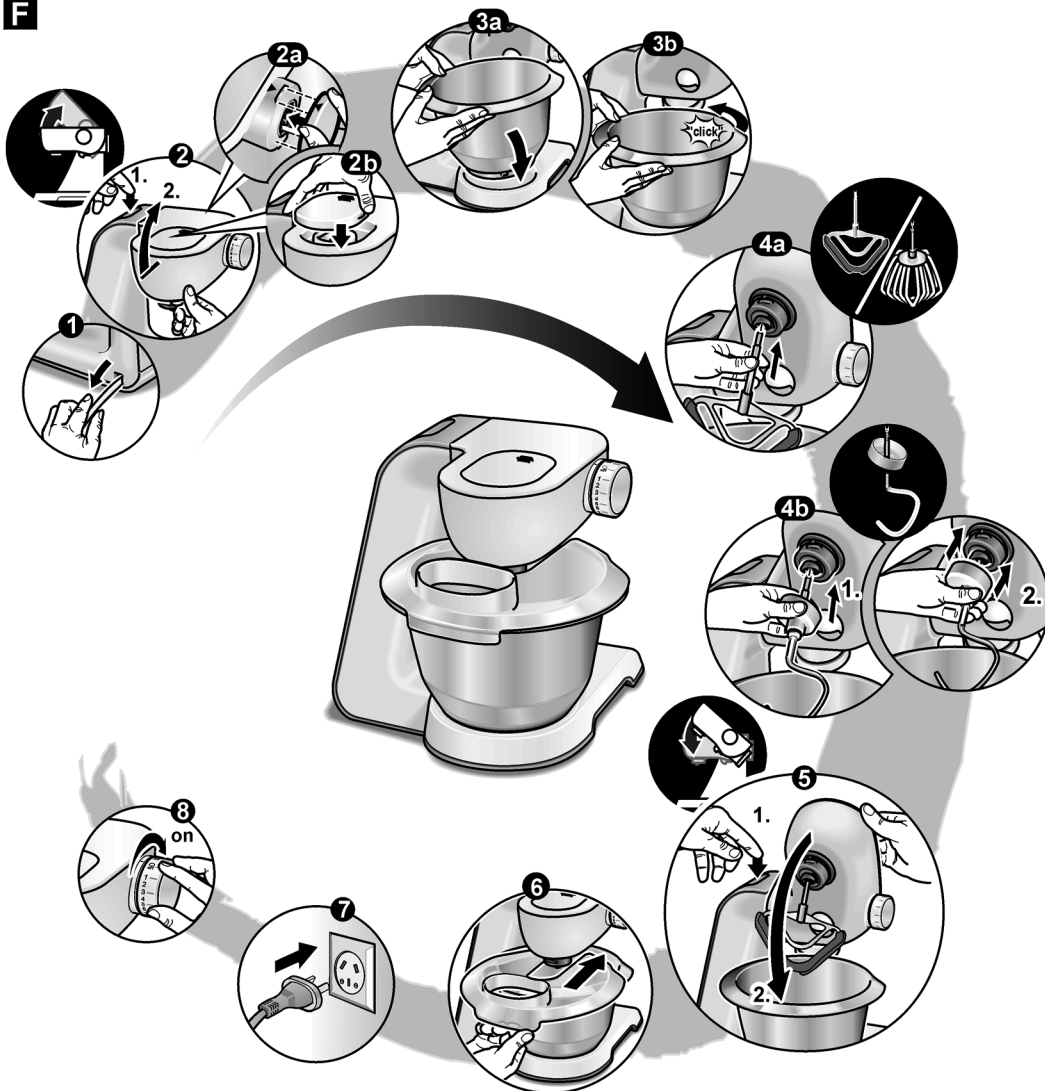
**E****F**

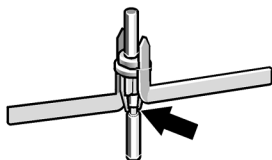
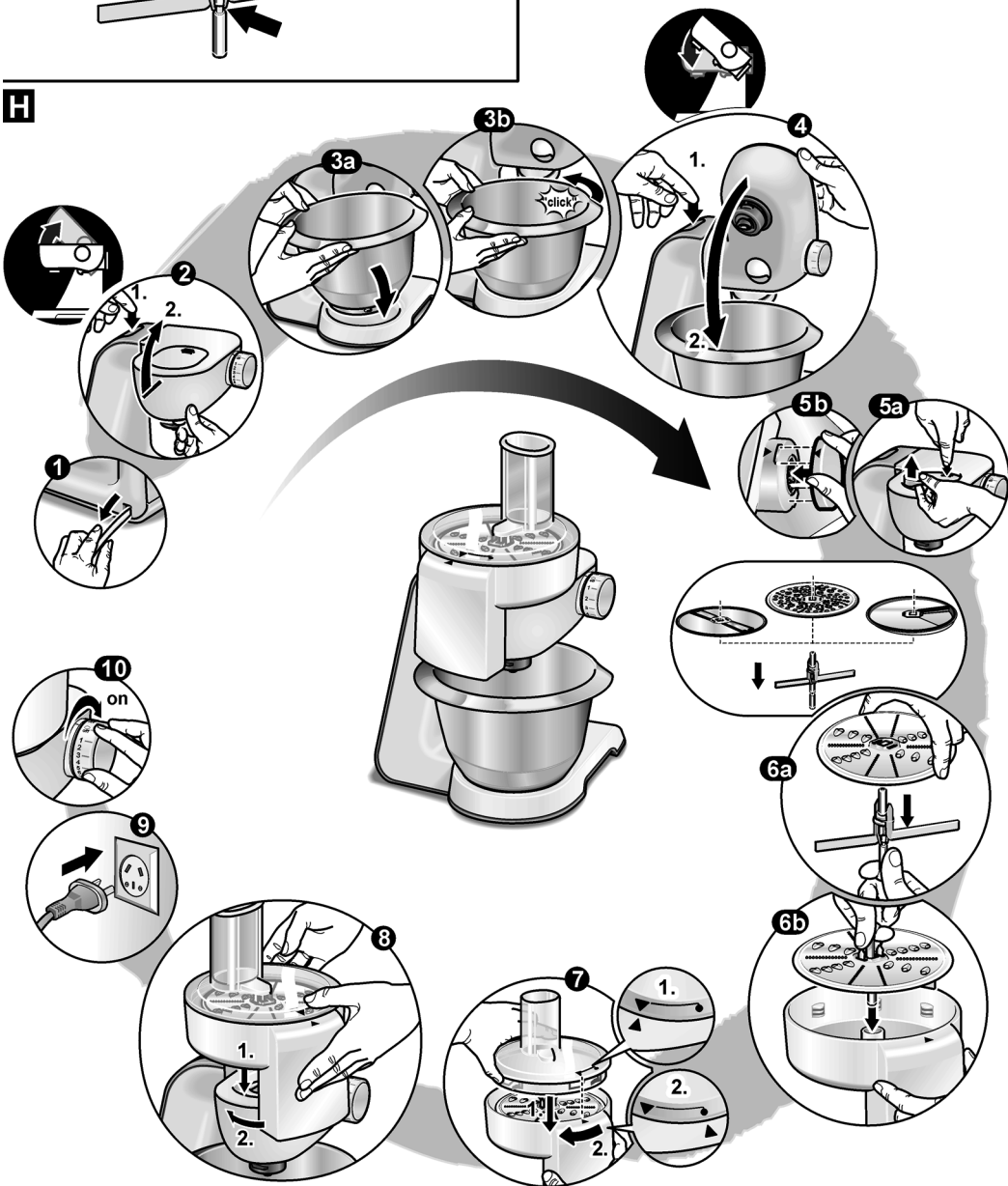
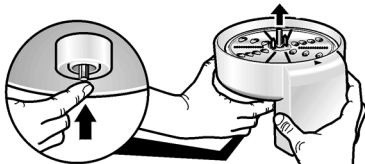
**G****H****J**

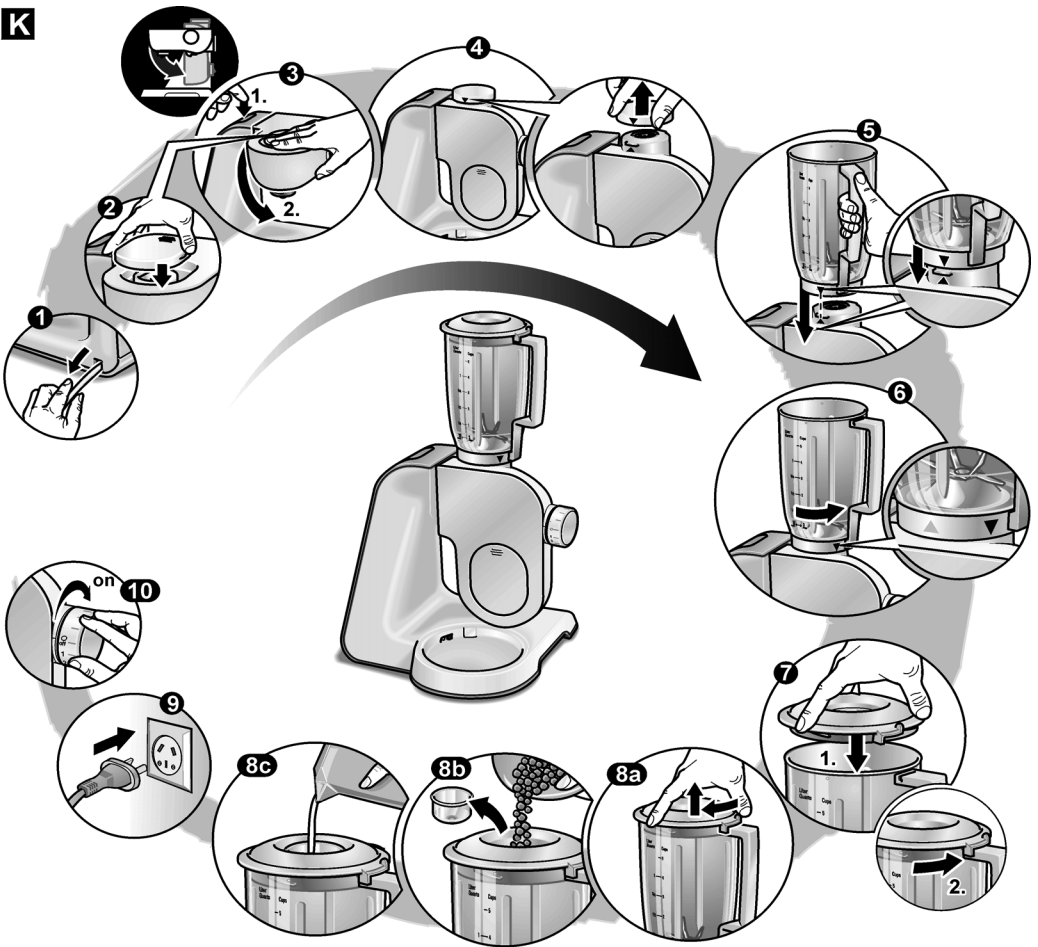
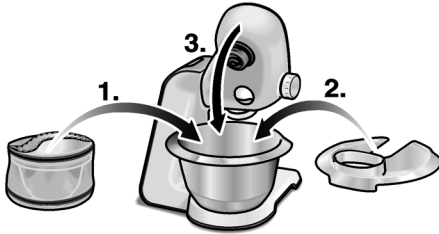
**K****L**

**M****MUM 57860AU****MUM 57860AU**